



精密数控设备专业制造商
Professional manufacturer of precision CNC equipment

Intelligence

Innovation

Efficiency

Professional manufacturer of precision
CNC equipment

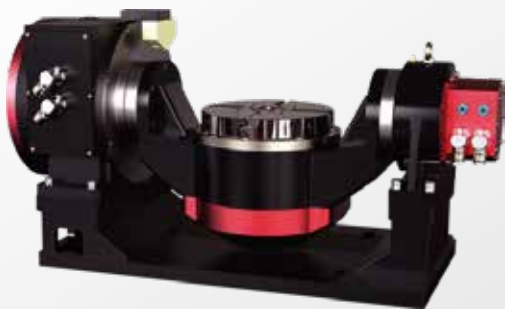

Shanghai Think Big Machine Tool Co.,Ltd

上海森克贝客机械工具有限公司

ABOUT US

Shanghai Think Big Machinery Co.,Ltd is the first overseas authorized enterprise of Chenxi Industrial Co., Ltd. established in 1990.

Owned processing plant, specialized in 30 years. It integrates research and development, precision processing and manufacturing, quality control and sales. Committed to building its own international brand.

Existing imported processing equipment: 40 computer numerical control lathes, 30 CNC vertical machining centers, 10 CNC horizontal machining centers, and more than 10 precision inner hole and outer circle grinding machines.

Precision testing equipment: Mitutoyo roughness gauge, height gauge, three coordinates, Renishaw interferometer, projector, etc.

CATALOG

- Cam Rotary Table(Four Axis)
- Disc Tailstock
 - Top Tailstock
 - Horizontal Toraty Table
 - Mechanical five-axis (Single arm tyle)
 - Mechanical five-axis (Cradle style)
 - Direct drive five-axis (Single arm style)
 - Direct drive five-axis(Cradle style)

Roller Cam Combination



Features:

- 1、 The core transmission mechanism adopts a cam transmission mechanism with high precision, zero backlashes, and wear resistance.
- 2、 The whole series adopts hydraulic full-circumference brake mechanism, with fast braking response (no delay) and large braking force Stable, accurate, long-term use, no attenuation.
- 3、 The whole series adopts YRT series turntable special crossed roller bearings, with higher radial load capacity. Better rigidity and accuracy retention of the whole machine.
- 4、 The design of the whole machine adopts imported seals, which are resistant to oil, water and high temperature, and have a longer service time.
- 5、 The changeable sheet metal design can stand or lie down, perfectly realizing the dual use of one machine.

TB-170 Parameters Table

| Item | Data |
|---|--------------------------------------|
| Rotary Table Diameter(mm) | Φ 170 |
| Hole Diameter(mm) | Φ 50 |
| Through-Hole Diameter(mm) | Φ 55 |
| Width of T-Slot(mm) | 12 |
| Width for Located Block at the bottom(mm) | 18 |
| Brake pressure (KG/CM ²) | Oil pressure 30~35KG/CM ² |
| Applicable ambient temperature | 10~50 |
| Least Input Increment | 0.001° |
| Speed Reduction Ratio | 1:60 |
| Indexing Accuracy | 20 |
| Index Repeatability | 4 |
| Vertical /Using Tail Stock | 75KG/150KG |
| Horizontal | 150KG |
| Gross weight | 67KG |
| Table Rotation Speed | 50 r.p.m. |
| Allowable cutting torque (KG.M) | 40 |
| Servo motor (optional) | FANUC (a iF4/β is8) |
| | MITSUBISHI (HF-104T) |
| | SIEMENS(IFK7060) |
| Form of use | Vertical and Horizontal |

TB-170

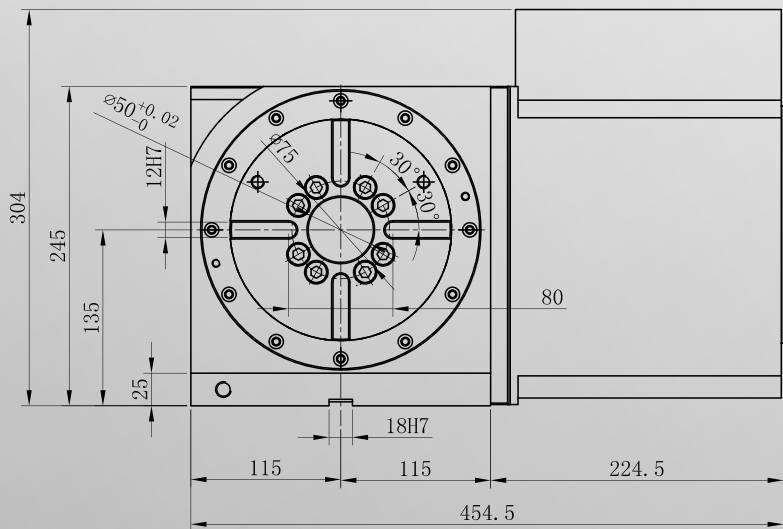
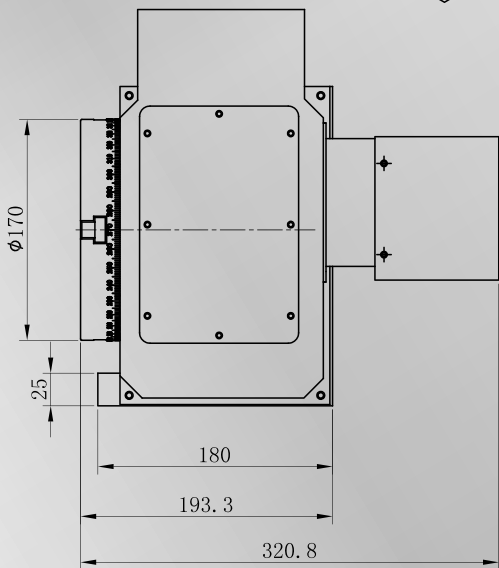
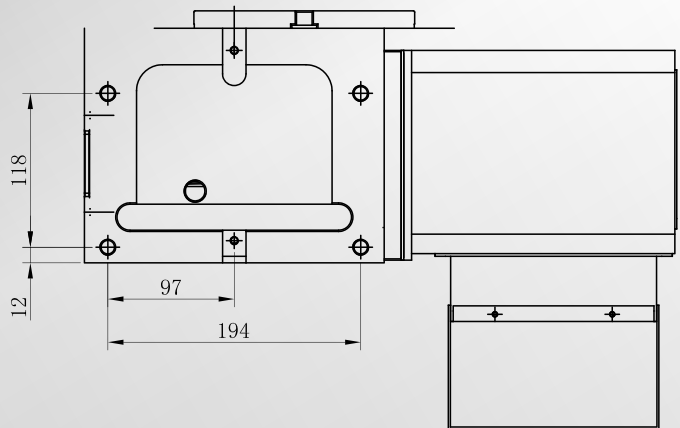
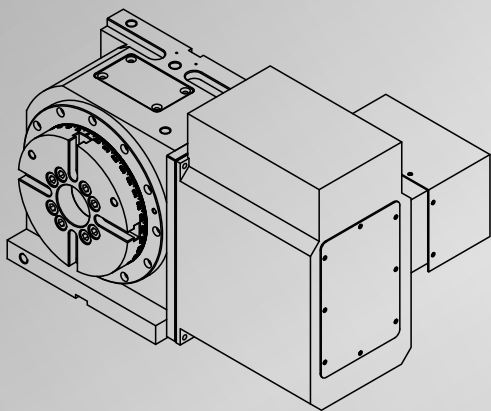

TB-200 Parameters Table

| Item | Data |
|---|--------------------------------------|
| Rotary Table Diameter(mm) | Φ200 |
| Hole Diameter(mm) | Φ50 |
| Through-Hole Diameter(mm) | Φ55 |
| Width of T-Slot(mm) | 12 |
| Width for Located Block at the bottom(mm) | 18 |
| Brake pressure (KG/CM ²) | Oil pressure 30~35KG/CM ² |
| Applicable ambient temperature | 10~50 |
| Least Input Increment | 0.001 |
| Speed Reduction Ratio | 1:60 |
| Indexing Accuracy | 20 |
| Index Repeatability | 4 |
| Vertical /Using Tail Stock | 100KG/200KG |
| Horizontal | 200KG |
| Gross weight | 82.4KG |
| Table Rotation Speed | 50 r.p.m. |
| Allowable cutting torque (KG.M) | 44 |
| Servo motor (optional) | FANUC (a iF4/β is8) |
| | MITSUBISHI (HF-104/154) |
| | SIEMENS(IFK7060) |
| Form of use | Vertical and Horizontal |

TB-200

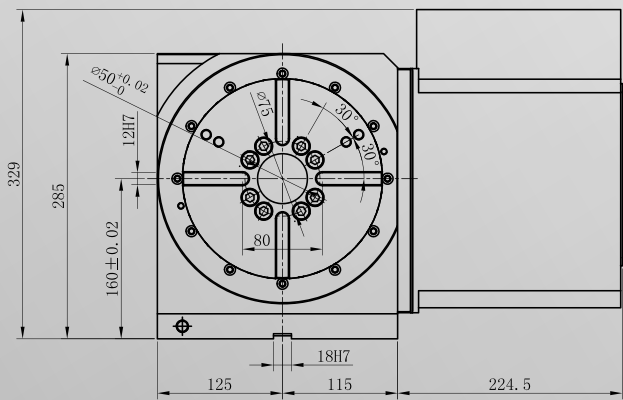
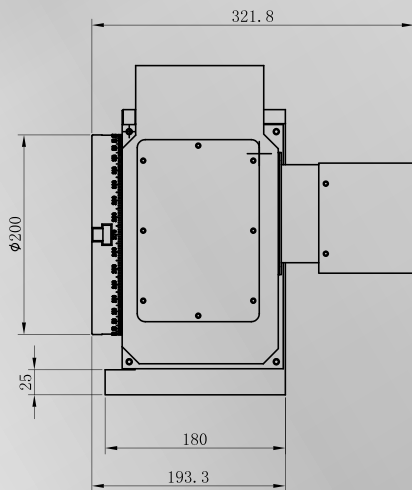
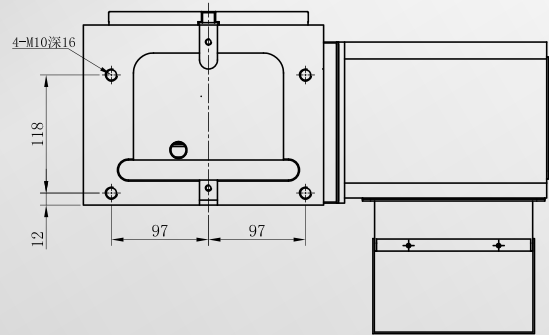
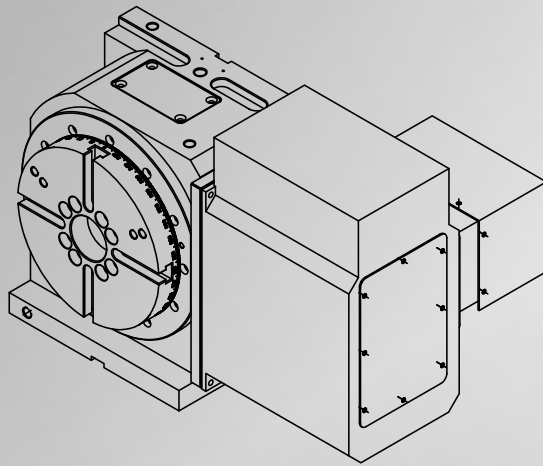

TB-200F Parameters Table

| Item | Data |
|---|--------------------------------------|
| Rotary Table Diameter(mm) | Φ200 |
| Hole Diameter(mm) | Φ50 |
| Through-Hole Diameter(mm) | Φ55 |
| Width of T-Slot(mm) | 12 |
| Width for Located Block at the bottom(mm) | 18 |
| Brake pressure (KG/CM ²) | Oil pressure 30~35KG/CM ² |
| Applicable ambient temperature | 10~50 |
| Least Input Increment | 0.001 |
| Speed Reduction Ratio | 1:60 |
| Indexing Accuracy | 20 |
| Index Repeatability | 4 |
| Vertical /Using Tail Stock | 100KG/200KG |
| Horizontal | 200KG |
| Gross weight | 82.4KG |
| Table Rotation Speed | 50 r.p.m. |
| Allowable cutting torque (KG.M) | 44 |
| Servo motor (optional) | FANUC (a iF4/β is8) |
| | MITSUBISHI (HF-104/154) |
| | SIEMENS(IFK7060) |
| Form of use | Vertical and Horizontal |

TB-200F

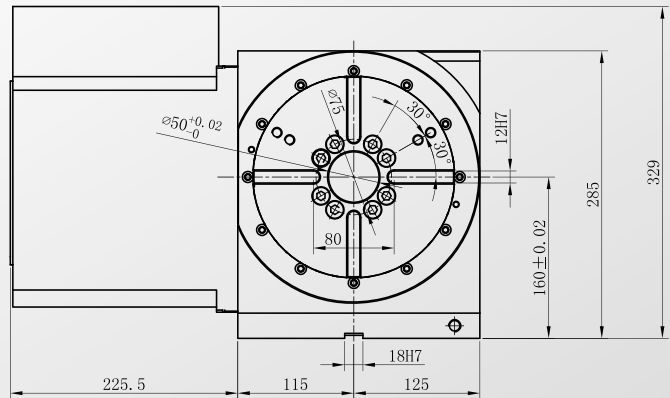
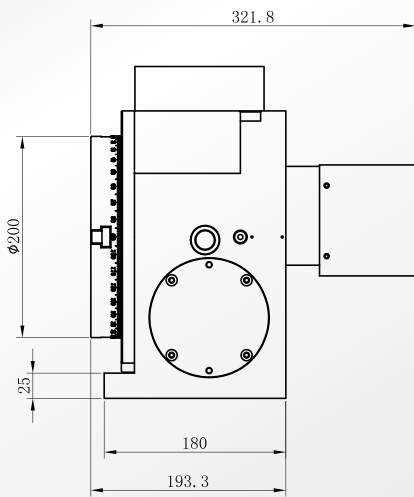
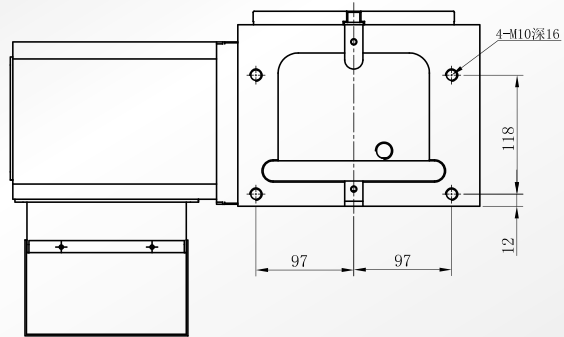
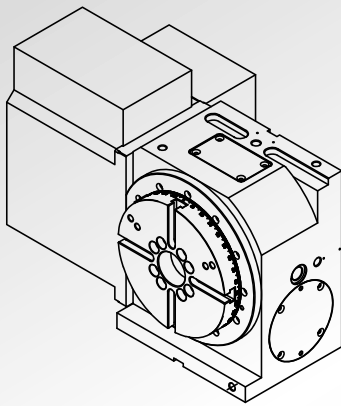

TB-250 Parameters Table

| Item | Data |
|---|--------------------------------------|
| Rotary Table Diameter(mm) | Φ250 |
| Hole Diameter(mm) | Φ50 |
| Through-Hole Diameter(mm) | Φ55 |
| Width of T-Slot(mm) | 12 |
| Width for Located Block at the bottom(mm) | 18 |
| Brake pressure (KG/CM ²) | Oil pressure 30~35KG/CM ² |
| Applicable ambient temperature | 10~50 |
| Least Input Increment | 0.001 |
| Speed Reduction Ratio | 1:60 |
| Indexing Accuracy | 20 |
| Index Repeatability | 4 |
| Vertical /Using Tail Stock | 150KG/300KG |
| Horizontal | 300KG |
| Gross weight | 87KG |
| Table Rotation Speed | 50 r.p.m. |
| Allowable cutting torque (KG.M) | 55 |
| Servo motor (optional) | FANUC (a iF4/β is8) |
| | MITSUBISHI (HF-104/154) |
| | SIEMENS(IFK7060) |
| Form of use | Vertical and Horizontal |

TB-250

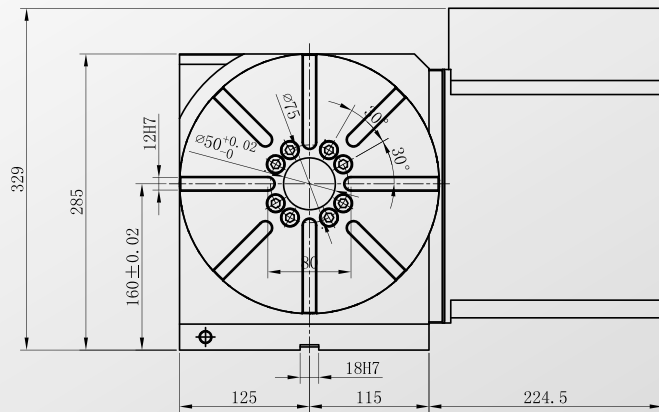
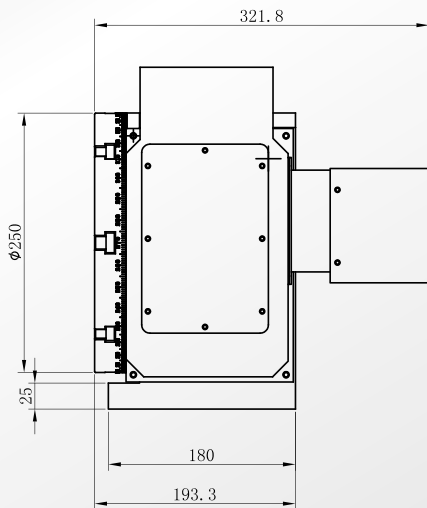
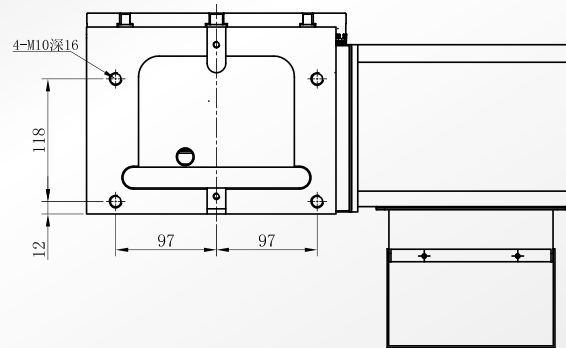
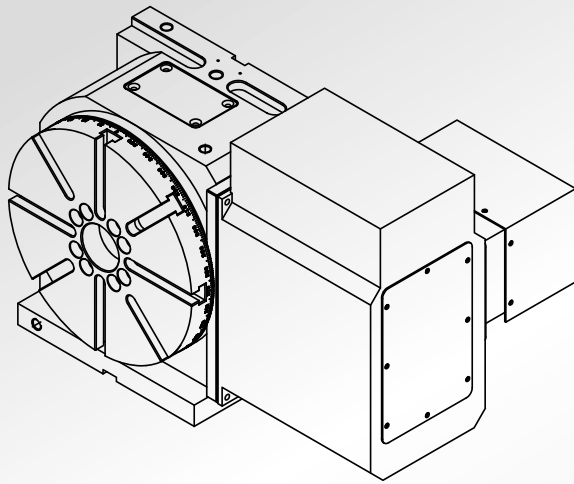

TB-250F Parameters Table

| Item | Data |
|---|--------------------------------------|
| Rotary Table Diameter(mm) | Φ250 |
| Hole Diameter(mm) | Φ50 |
| Through-Hole Diameter(mm) | Φ55 |
| Width of T-Slot(mm) | 12 |
| Width for Located Block at the bottom(mm) | 18 |
| Brake pressure (KG/CM ²) | Oil pressure 30~35KG/CM ² |
| Applicable ambient temperature | 10~50 |
| Least Input Increment | 0.001 |
| Speed Reduction Ratio | 1:60 |
| Indexing Accuracy | 20 |
| Index Repeatability | 4 |
| Vertical /Using Tail Stock | 150KG/300KG |
| Horizontal | 300KG |
| Gross weight | 87KG |
| Table Rotation Speed | 50 r.p.m. |
| Allowable cutting torque (KG.M) | 55 |
| Servo motor (optional) | FANUC (a iF4/β is8) |
| | MITSUBISHI (HF-104/154) |
| | SIEMENS(IFK7060) |
| Form of use | Vertical and Horizontal |

TB-250F

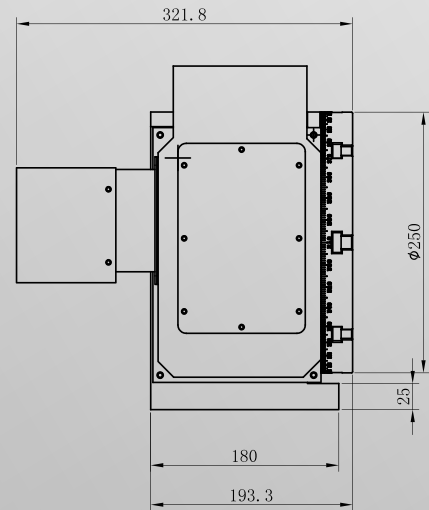
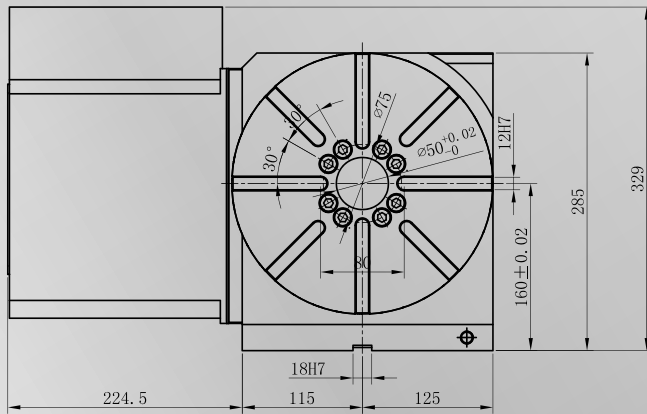
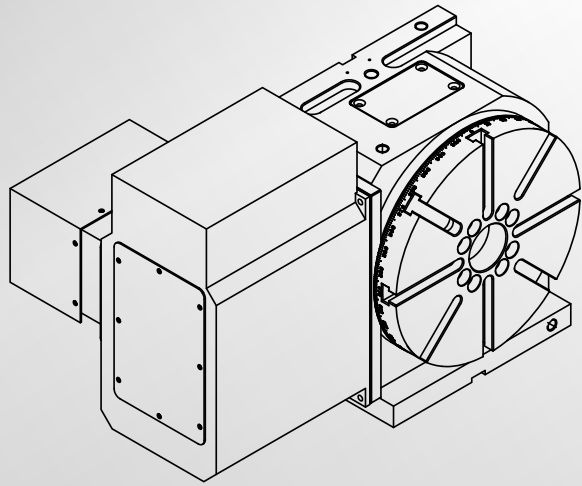
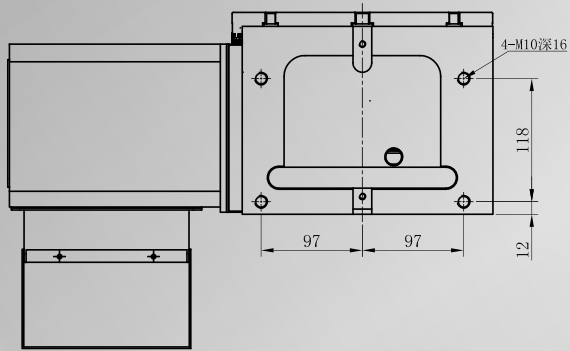

TB-320 Parameters Table

| Item | Data |
|---|--------------------------------------|
| Rotary Table Diameter(mm) | Φ 320 |
| Hole Diameter(mm) | Φ 110H7 |
| Center Height(mm) | 210 |
| Through-Hole Diameter(mm) | Φ 110 |
| Width of T-Slot(mm) | 14H7 |
| Width for Located Block at the bottom(mm) | 18H7 |
| Brake pressure (KG/CM ²) | Oil pressure 30~35KG/CM ² |
| Applicable ambient temperature | 10~50 |
| Least Input Increment | 0.001 |
| Speed Reduction Ratio | 1:72 |
| Indexing Accuracy | 15 |
| Index Repeatability | 4 |
| Vertical /Using Tail Stock | 200KG/500KG |
| Horizontal | 500KG |
| Gross weight | 220KG |
| Table Rotation Speed | 41 r.p.m. |
| Allowable cutting torque (KG.M) | 110 |
| Servo motor (optional) | FANUC (a iF12/β is22) |
| | MITSUBISHI (HF-204S) |
| | SIEMENS(IFK7083) |
| Form of use | Vertical and Horizontal |

TB-320

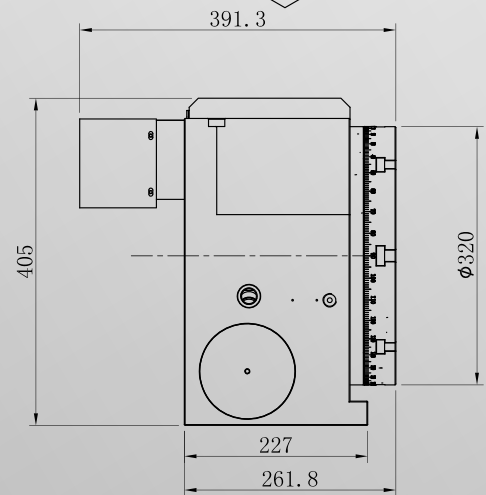
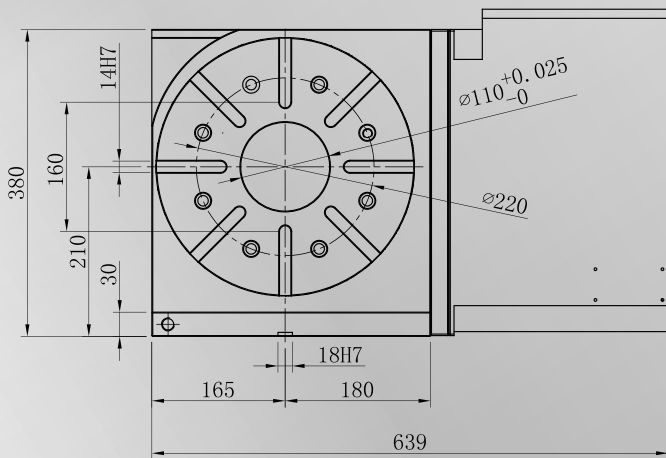
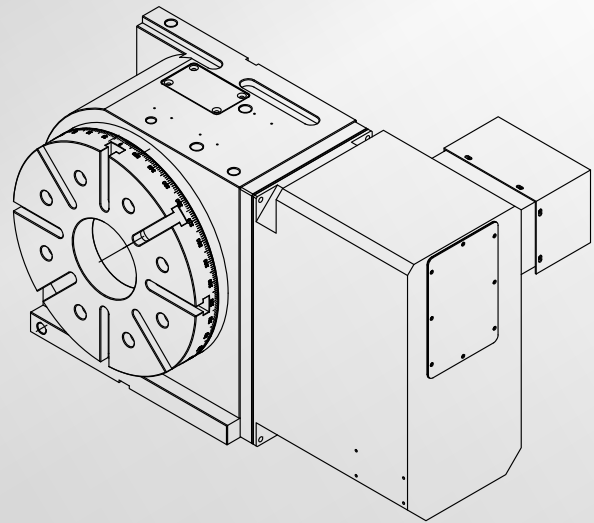
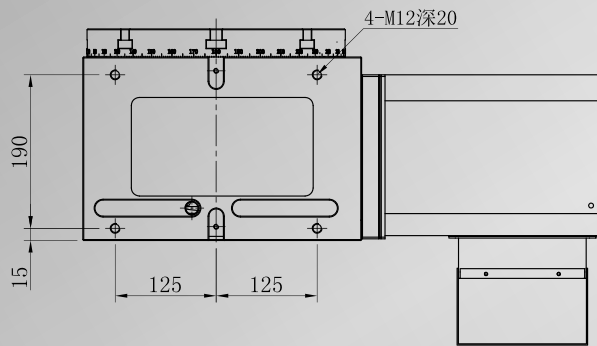

TB-400 Parameters Table

| Item | Data |
|---|--------------------------------------|
| Rotary Table Diameter(mm) | Φ400 |
| Hole Diameter(mm) | Φ110H7 |
| Center Height(mm) | 255 |
| Through-Hole Diameter(mm) | Φ110 |
| Width of T-Slot(mm) | 14H7 |
| Width for Located Block at the bottom(mm) | 18H7 |
| Brake pressure (KG/CM ²) | Oil pressure 30~35KG/CM ² |
| Applicable ambient temperature | 10~50 |
| Least Input Increment | 0.001 |
| Speed Reduction Ratio | 1:72 |
| Indexing Accuracy | 15 |
| Index Repeatability | 4 |
| Vertical /Using Tail Stock | 350KG/700KG |
| Horizontal | 700KG |
| Gross weight | 276KG |
| Table Rotation Speed | 41 r.p.m. |
| Allowable cutting torque (KG.M) | 180 |
| Servo motor (optional) | FANUC (a iF12/β is22) |
| | MITSUBISHI (HF-204S) |
| | SIEMENS(IFK7083) |
| Form of use | Vertical and Horizontal |

TB-400

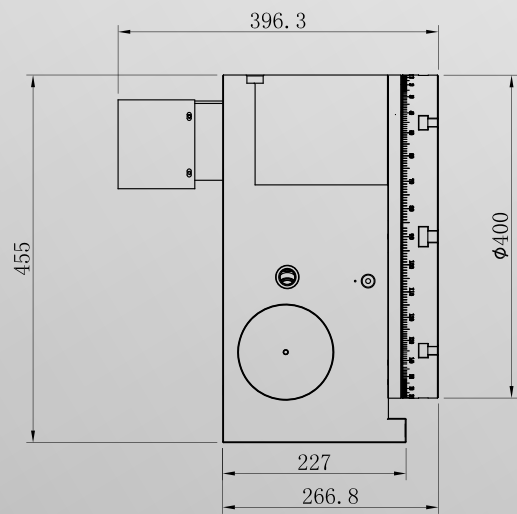
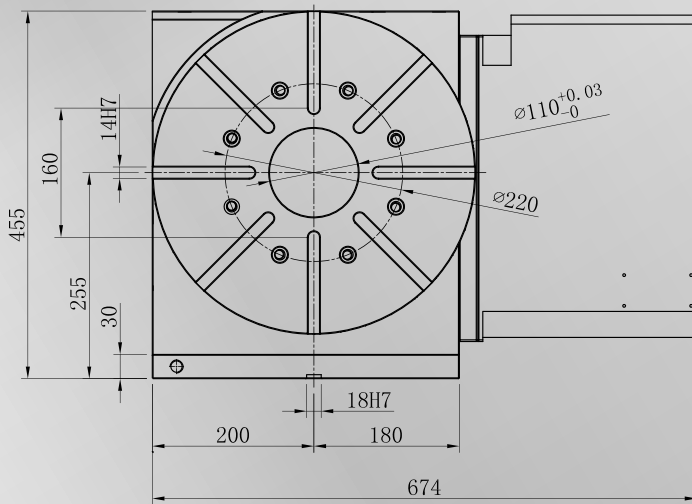
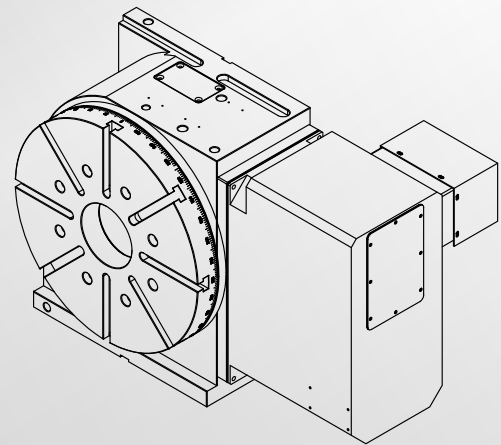
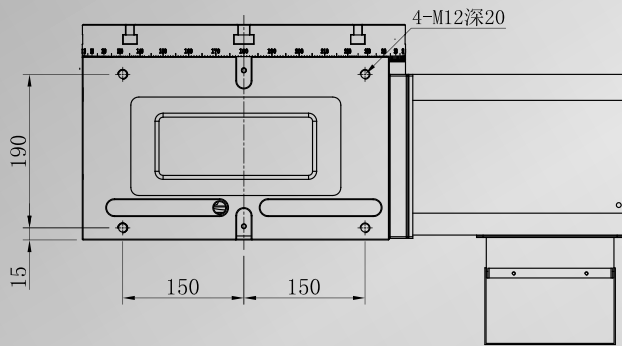

DC Series Horizontal Turntable



Features:

- 1、 The whole system adopts a cam transmission mechanism, and the minimum division accuracy can be achieved at 0.001.
- 2、 Based on the principle of double-bearing design, the rigidity can be increased by 30% compared with similar products.
- 3、 The whole system is designed with a super large hydraulic encircling brake mechanism, which perfectly solves the problems of braking delay, positioning deviation and insufficient braking force.
- 4、 Each model adopts the golden speed ratio, and the comprehensive performance is outstanding.

DC-500 Parameters Table

| Item | Data |
|---|--------------------------------------|
| Rotary Table Diameter(mm) | 500 × 500 |
| Hole Diameter(mm) | Φ50H7 |
| Center Height(mm) | - |
| Through-Hole Diameter(mm) | - |
| Width of T-Slot(mm) | 18H7 |
| Width for Located Block at the bottom(mm) | 18H7 |
| Brake pressure (KG/CM ²) | Oil pressure 30~35KG/CM ² |
| Applicable ambient temperature | 10~50 |
| Least Input Increment | 0.001 |
| Speed Reduction Ratio | 1:72 |
| Indexing Accuracy | 15 |
| Index Repeatability | 4 |
| Vertical /Using Tail Stock | - |
| Horizontal | 800KG |
| Gross weight | 405KG |
| Table Rotation Speed | 41 r.p.m. |
| Allowable cutting torque (KG.M) | 180 |
| Servo motor (optional) | FANUC (a iF12/β is22) |
| | MITSUBISHI (HF-204S) |

DC-500

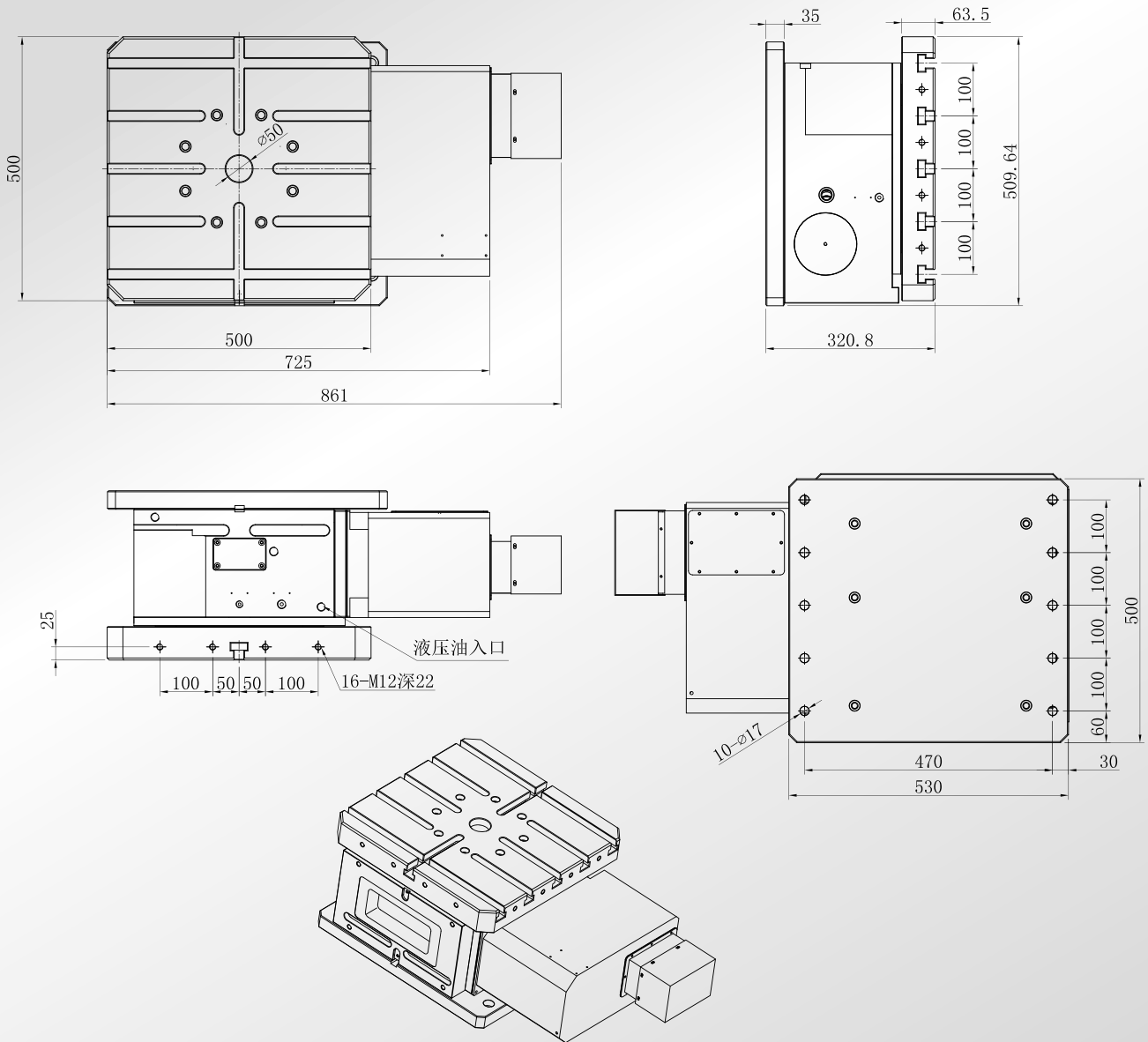

DC-630 Parameters Table

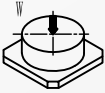
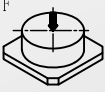
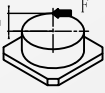
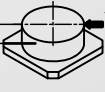
| Item | Data | Data | |
|--|---|----------------------------------|-------|
| Turntable diameter | mm | 630*630 | |
| Turntable height | mm | 360 | |
| Center hole | mm | Φ50 | |
| Motor standard specifications (direct axis motor) Other specifications brand consulting customization | | FANUC-β is22 MITSUBISHI-HF204 | |
| Width of T-Slot | mm | 18H7 | |
| Minimum angle setting unit | deg | 0.001 | |
| Maximum number of revolutions | rpm | 25 | |
| Total reduction ratio | | 1:90 | |
| Indexing Accuracy | arc · sec | ± 10 | |
| Index Repeatability | arc · sec | 4 | |
| Locking method (hydraulic pressure) | Mpa | 4.5 ± 0.5 | |
| Locking torque | N · m | 4600 | |
| Continuous cutting torque | N · m | 2800 | |
| Maximum cutting torque (when the brake is locked) | N · m | 4600 | |
| Product quality | kg | 850 | |
| Load |  | kg | 1200 |
| Allowable load | F  | N | 65000 |
| | FXL  | N · m | 4600 |
| | FXL  | N · m | 9500 |

DC-630

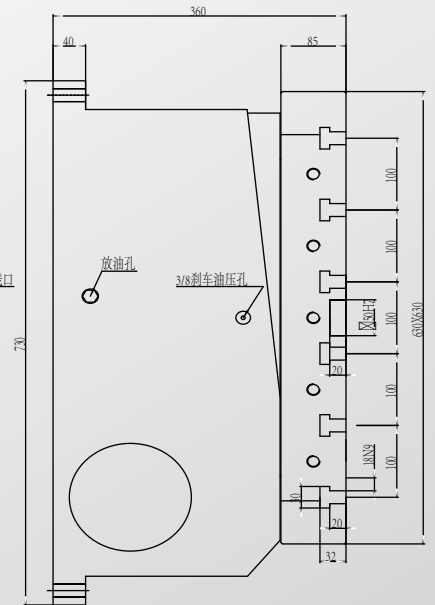
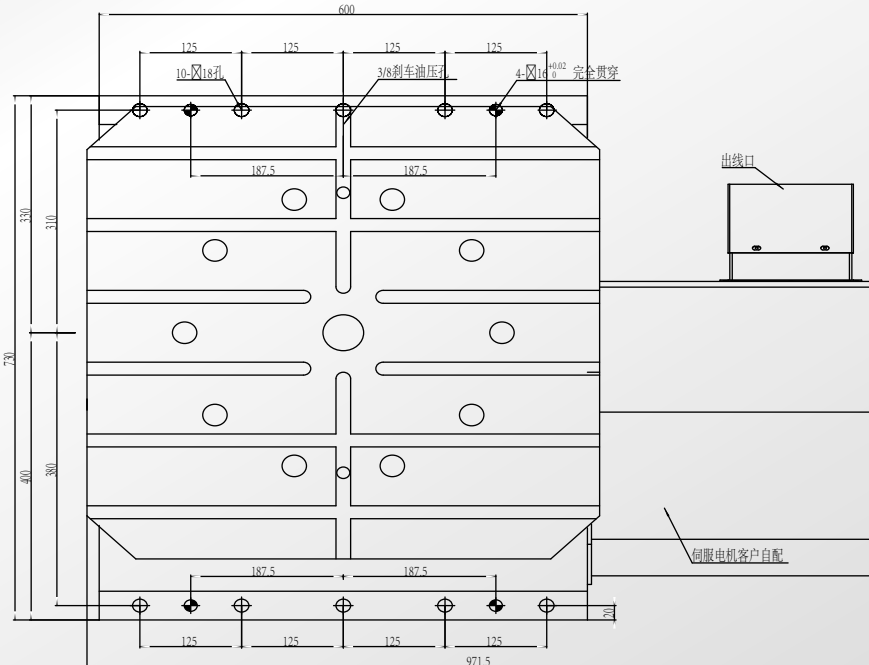
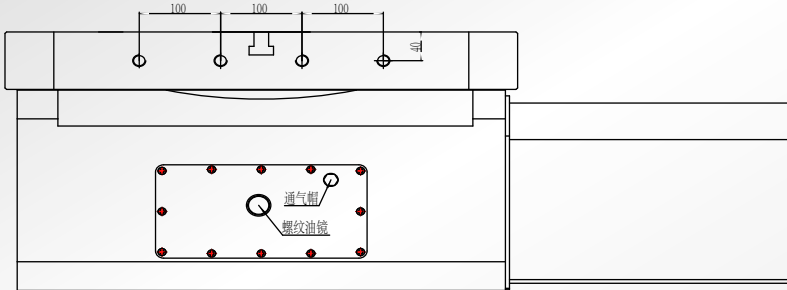
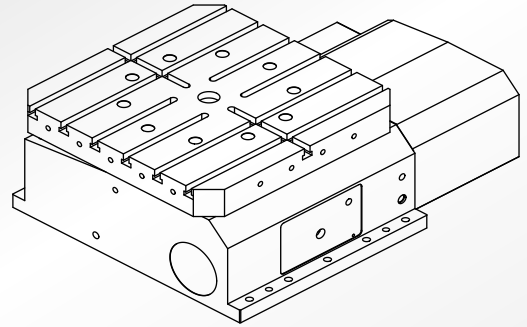

Turbine shaft

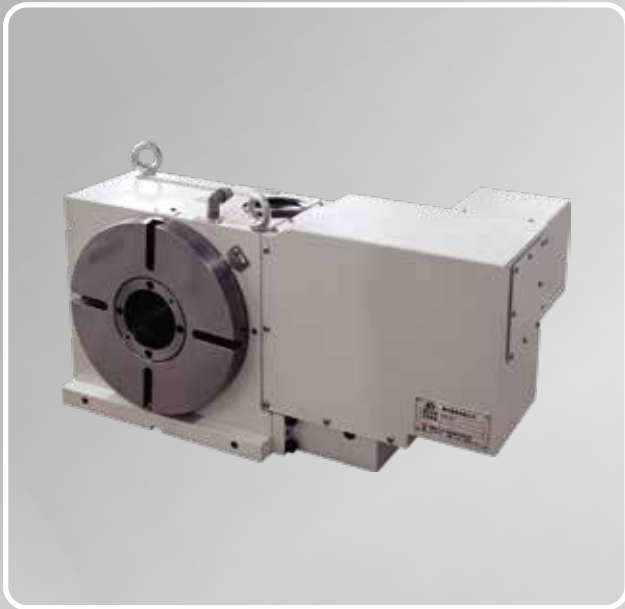

Features:

- 1、 The whole series adopts the imported JIS double-lead worm pair, with high transmission positioning accuracy. The aluminum bronze worm gear is more wear-resistant to damage and has excellent accuracy retention.
- 2、 The whole series adopts a high-precision cross-roller bearing design, which has higher rotation accuracy and rigidity, is resistant to heavy cutting, and maintains Long-term processing stability.
- 3、 Double-lead worm design, adjustable clearance, improve the service time of the whole machine.

WB-170 Parameters Table

| Item | Data |
|---|---|
| Rotary Table Diameter(mm) | Φ 170 |
| Hole Diameter(mm) | Φ 50 |
| Through-Hole Diameter(mm) | Φ 45 |
| Width of T-Slot(mm) | 12 |
| Width for Located Block at the bottom(mm) | 14 |
| Brake pressure (KG/CM ²) | Barometric Pressure 6KG/CM ² |
| Applicable ambient temperature | 10~50 |
| Least Input Increment | 0.001 |
| Speed Reduction Ratio | 1:72 |
| Indexing Accuracy | 20 |
| Index Repeatability | 4 |
| Vertical /Using Tail Stock | 75KG/150KG |
| Horizontal | - |
| Gross weight | 42KG |
| Table Rotation Speed | 41.6 r.p.m. |
| Allowable cutting torque (KG.M) | 40 |
| Servo motor (optional) | FANUC (a iF4/β is8) |
| | MITSUBISHI (HF-104T) |
| | SIEMENS(IFK7060) |
| Form of use | Vertical |

WB-200 Parameters Table

| Item | Data |
|---|--------------------------------------|
| Rotary Table Diameter(mm) | Φ200 |
| Hole Diameter(mm) | Φ50 |
| Through-Hole Diameter(mm) | Φ45 |
| Width of T-Slot(mm) | 12 |
| Width for Located Block at the bottom(mm) | 18 |
| Brake pressure (KG/CM ²) | Oil pressure 25~30KG/CM ² |
| Applicable ambient temperature | 10~50 |
| Least Input Increment | 0.001 |
| Speed Reduction Ratio | 1:72 |
| Indexing Accuracy | 20 |
| Index Repeatability | 4 |
| Vertical /Using Tail Stock | 100KG/200KG |
| Horizontal | 200KG |
| Gross weight | 55KG |
| Table Rotation Speed | 41.6 r.p.m. |
| Allowable cutting torque (KG.M) | 40 |
| Servo motor (optional) | FANUC (a iF4/β is8) |
| | MITSUBISHI (HF-104/154) |
| | SIEMENS(IFK7060) |
| Form of use | Vertical and Horizontal |

WB-200

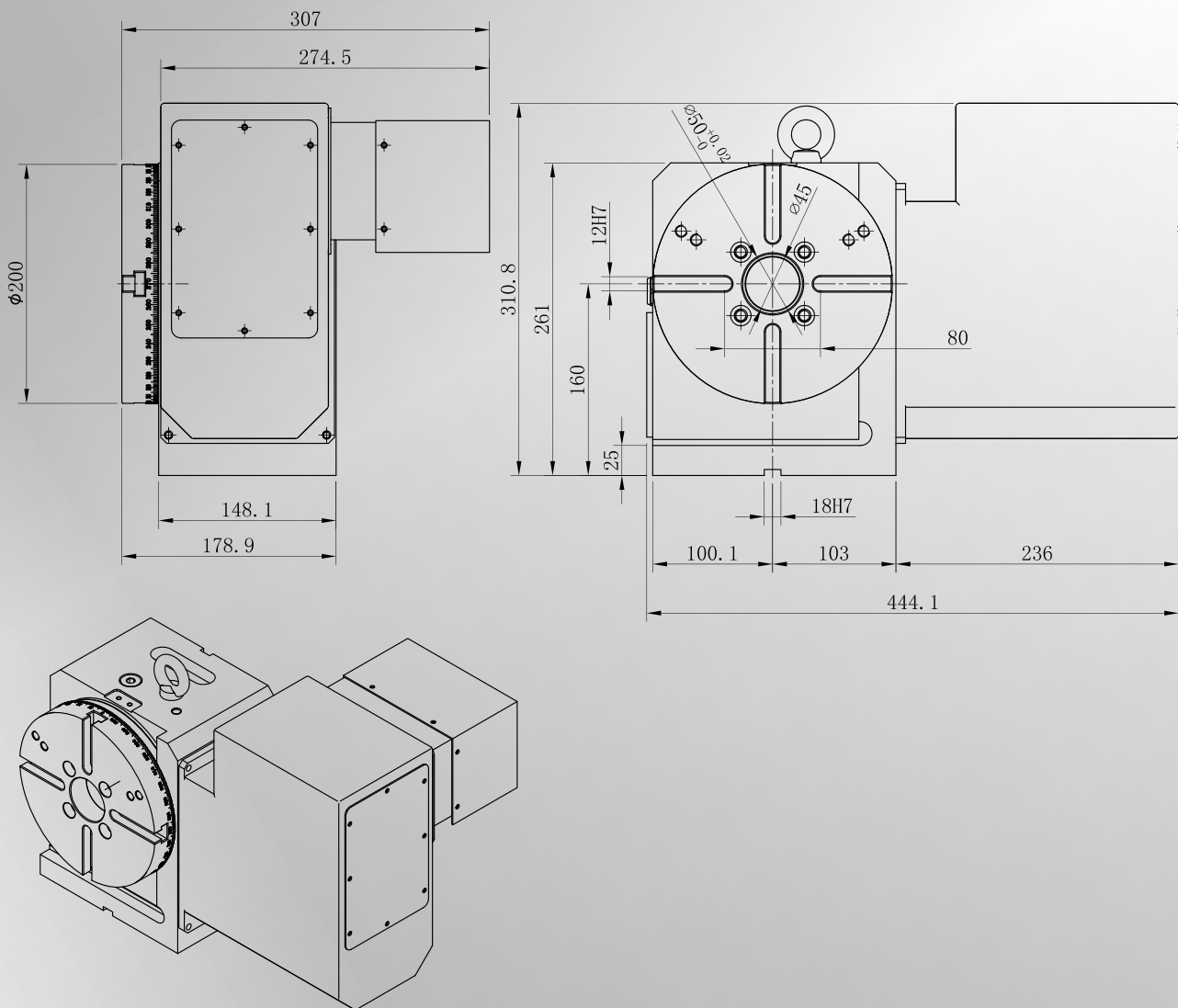

WB-255 Parameters Table

| Item | Data |
|---|--------------------------------------|
| Rotary Table Diameter(mm) | Φ255 |
| Hole Diameter(mm) | Φ80 |
| Through-Hole Diameter(mm) | Φ80 |
| Width of T-Slot(mm) | 12 |
| Width for Located Block at the bottom(mm) | 18 |
| Brake pressure (KG/CM ²) | Oil pressure 30~35KG/CM ² |
| Applicable ambient temperature | 10~50 |
| Least Input Increment | 0.001 |
| Speed Reduction Ratio | 1:120 |
| Indexing Accuracy | 20 |
| Index Repeatability | 4 |
| Vertical /Using Tail Stock | 150KG/300KG |
| Horizontal | 107KG |
| Gross weight | 82.4KG |
| Table Rotation Speed | 25 r.p.m. |
| Allowable cutting torque (KG.M) | 55 |
| Servo motor (optional) | FANUC (a iF4/β is8) |
| | MITSUBISHI (HF-104/154) |
| | SIEMENS(IFK7060) |
| Form of use | Vertical and Horizontal |

WB-255

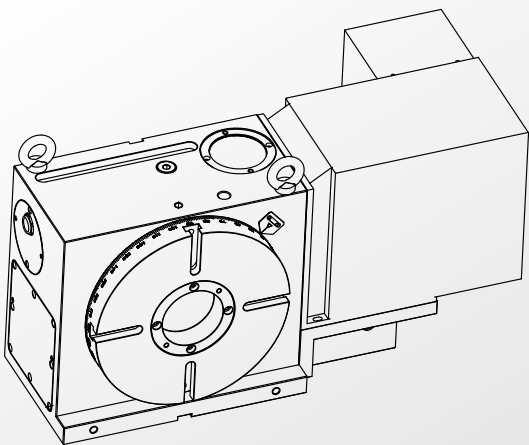
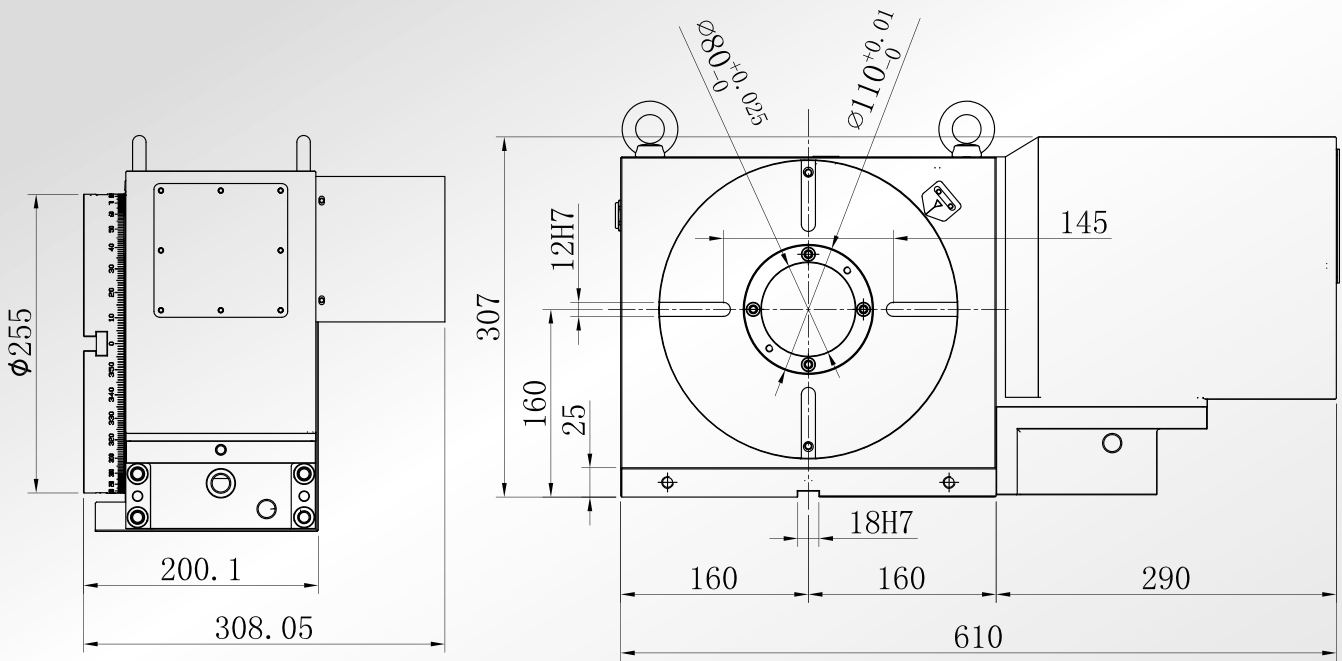

Disc tailstock combination

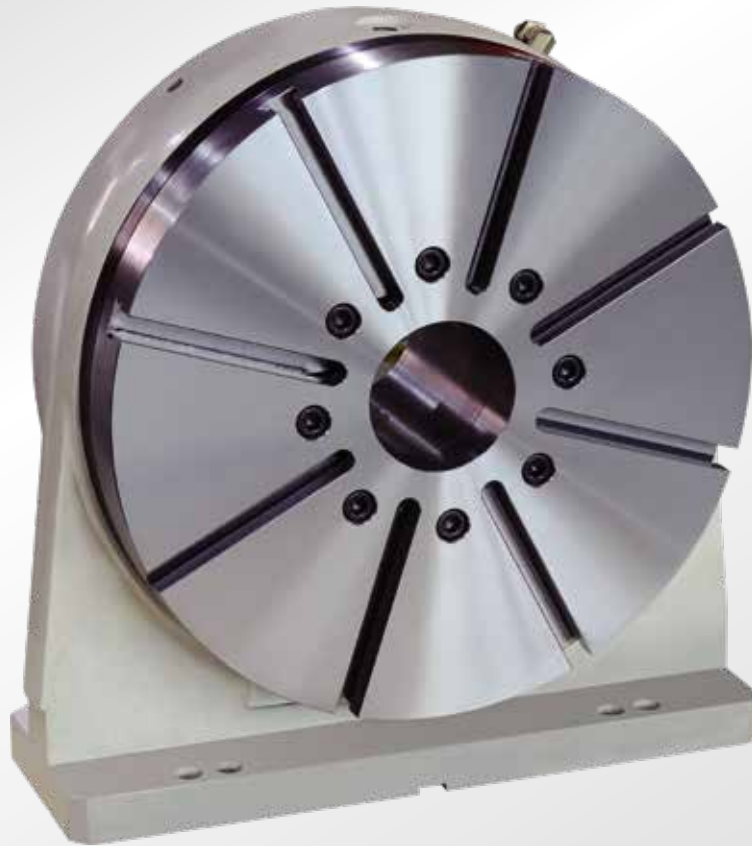

W135-170

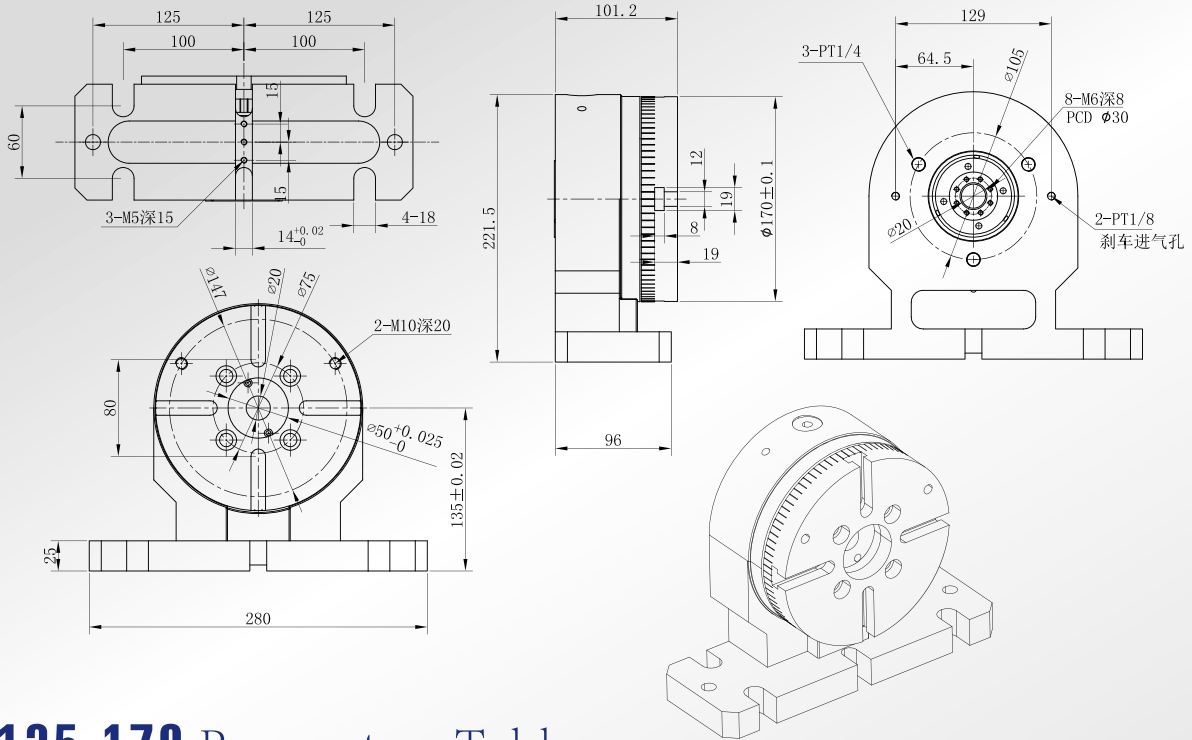

W135-170 Parameters Table

| Item | Data |
|---|----------------------|
| Rotary Table Diameter(mm) | Φ 170 |
| Hole Diameter(mm) | Φ 50 |
| Through-Hole Diameter(mm) | Φ 20 |
| Center Height(mm) | 135 |
| Hole Diameter(mm) | 12 |
| Width for Located Block at the bottom(mm) | 14 |
| Brake pressure (KG/CM ²) | 30KG/CM ² |
| Gross weight | 21.25KG |

W160-200

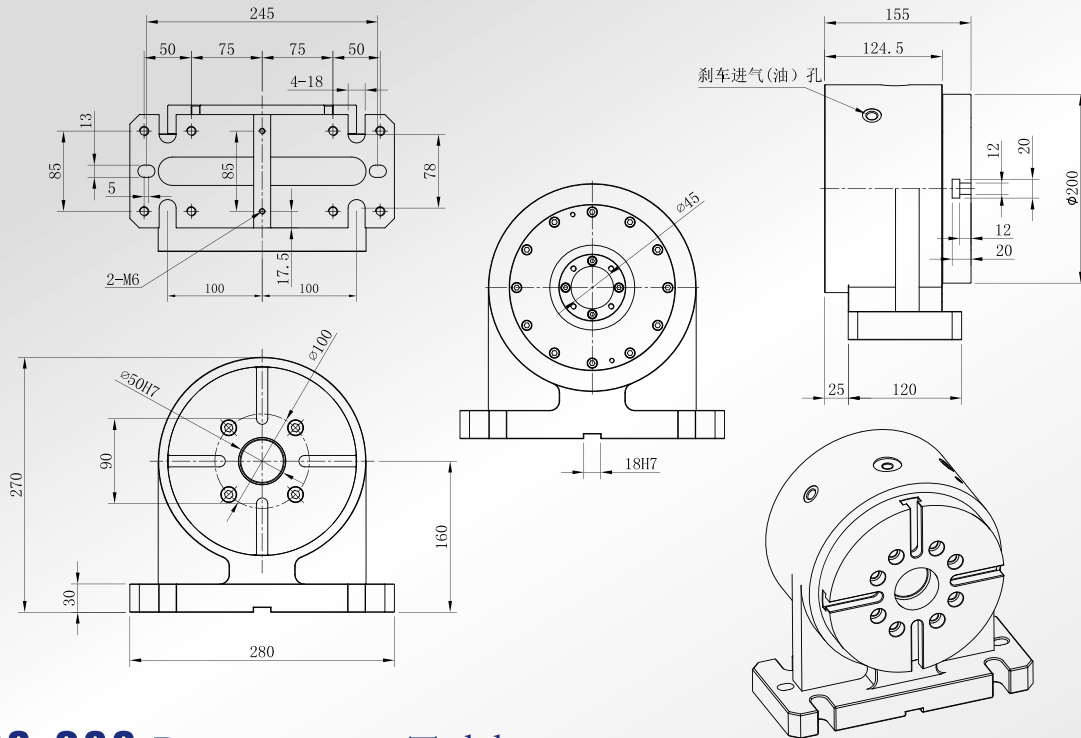

W160-200 Parameters Table

| Item | Data |
|---|----------------------|
| Rotary Table Diameter(mm) | Φ 200 |
| Hole Diameter(mm) | Φ 50 |
| Through-Hole Diameter(mm) | Φ 45 |
| Center Height(mm) | 160 |
| Width of T-Slot(mm) | 12 |
| Width for Located Block at the bottom(mm) | 18 |
| Brake pressure (KG/CM ²) | 30KG/CM ² |
| Gross weight | 45.15KG |

W160-250

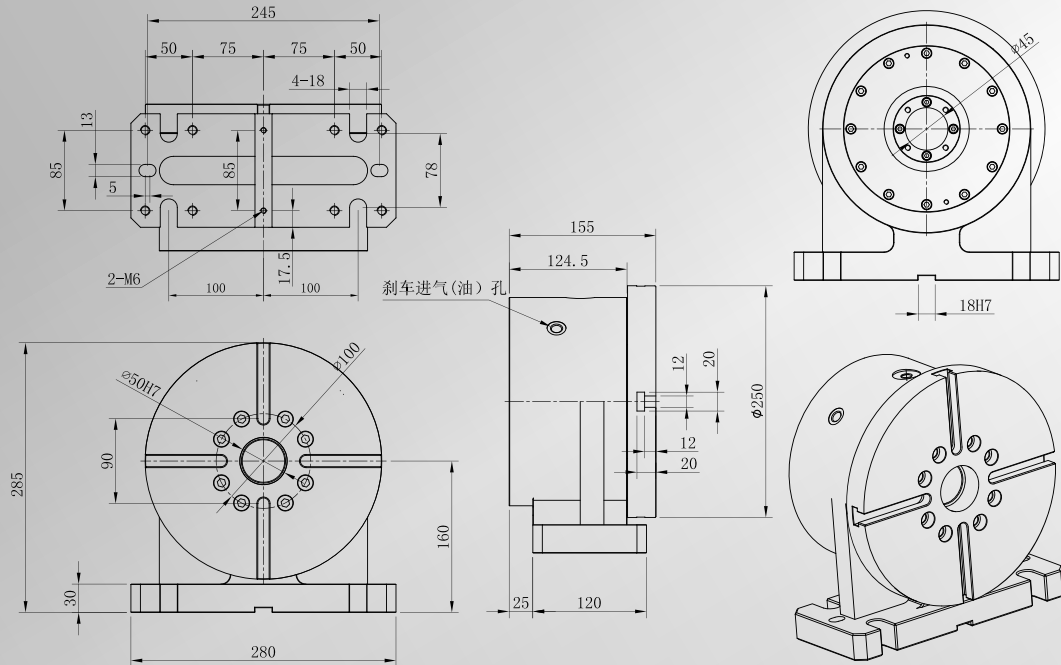

W160-250 Parameters Table

| Item | Data |
|---|----------------------|
| Rotary Table Diameter(mm) | Φ 250 |
| Hole Diameter(mm) | Φ 50 |
| Through-Hole Diameter(mm) | Φ 45 |
| Center Height(mm) | 160 |
| Width of T-Slot(mm) | 12 |
| Width for Located Block at the bottom(mm) | 18 |
| Brake pressure (KG/CM ²) | 30KG/CM ² |
| Gross weight | 49.8KG |

W160-255

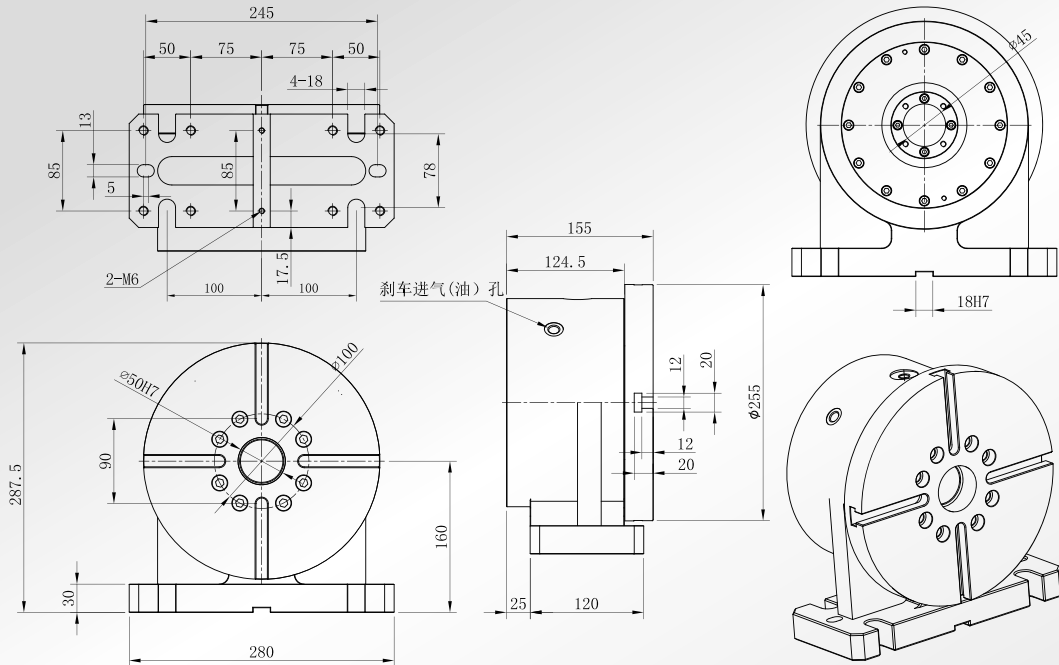

W160-255 Parameters Table

| Item | Data |
|---|----------------------|
| Rotary Table Diameter(mm) | Φ 255 |
| Hole Diameter(mm) | Φ 50 |
| Through-Hole Diameter(mm) | Φ 45 |
| Center Height(mm) | 160 |
| Width of T-Slot(mm) | 12 |
| Width for Located Block at the bottom(mm) | 18 |
| Brake pressure (KG/CM ²) | 30KG/CM ² |
| Gross weight | 50.4KG |

W210-320

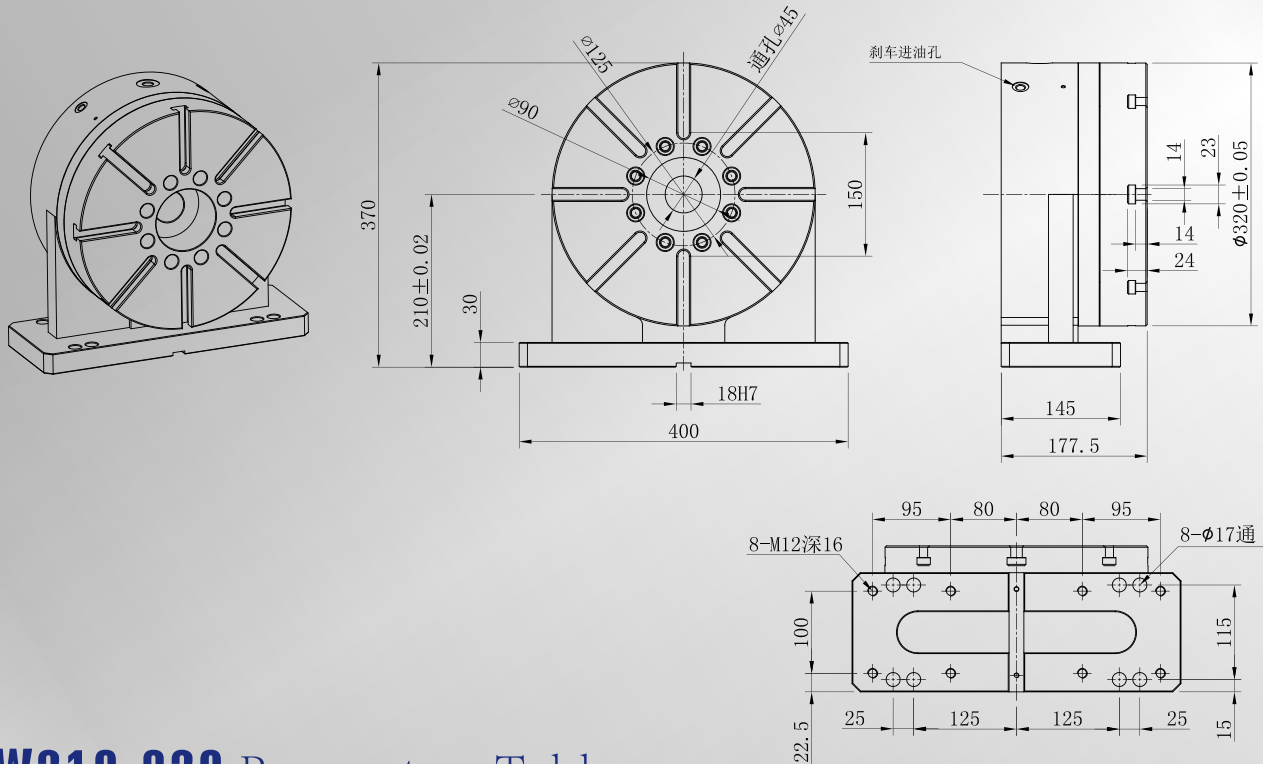

W210-320 Parameters Table

| Item | Data |
|---|----------------------|
| Rotary Table Diameter(mm) | Φ 320 |
| Hole Diameter(mm) | Φ 90 |
| Through-Hole Diameter(mm) | Φ 45 |
| Center Height(mm) | 210 |
| Width of T-Slot(mm) | 14 |
| Width for Located Block at the bottom(mm) | 18 |
| Brake pressure (KG/CM ²) | 30KG/CM ² |
| Gross weight | 109.8KG |

W255-400

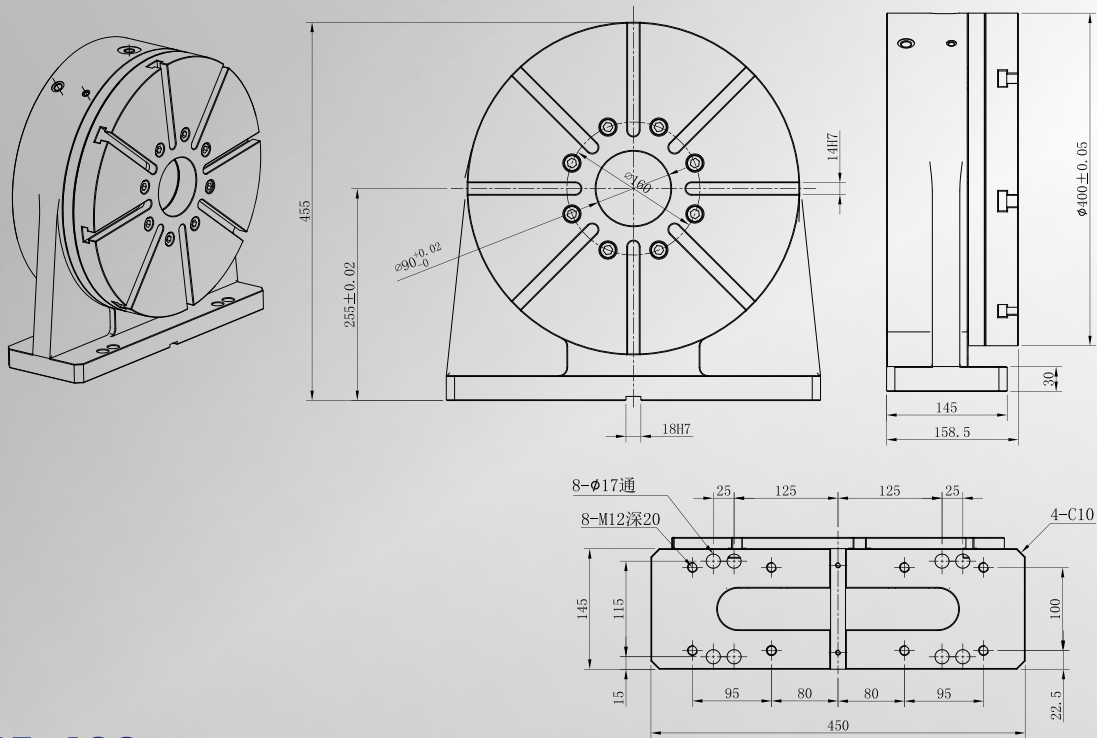

W255-400 Parameters Table

| Item | Data |
|---|----------------------|
| Rotary Table Diameter(mm) | Φ 400 |
| Hole Diameter(mm) | Φ 90 |
| Through-Hole Diameter(mm) | Φ 95 |
| Center Height(mm) | 255 |
| Width of T-Slot(mm) | 14 |
| Width for Located Block at the bottom(mm) | 18 |
| Brake pressure (KG/CM ²) | 30KG/CM ² |
| Gross weight | 136.5KG |

DDR Direct Drive Turntable

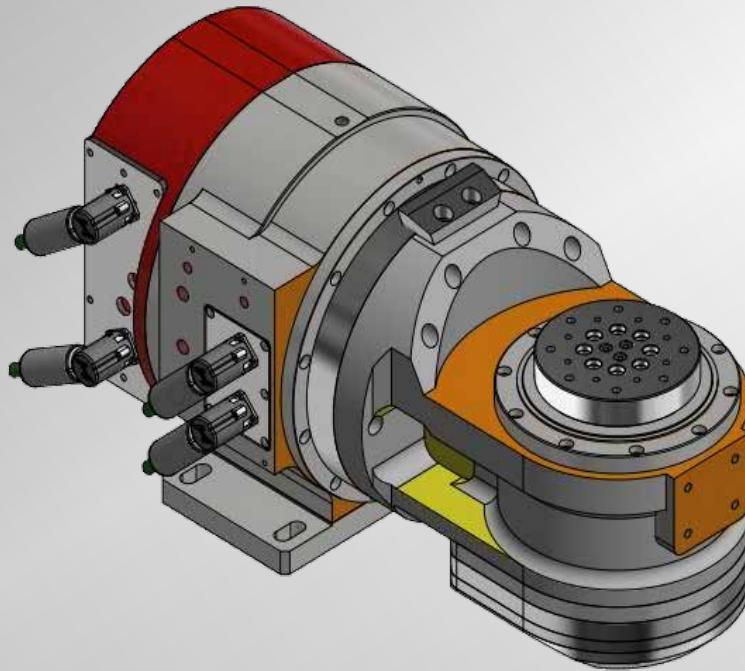

Features:

- 1、It is directly driven by a large torque motor, with no transmission, no mechanical wear, high speed, high precision, and zero backlashes.
- 2、It adopts a full-circle embracing brake mechanism, with fast braking response, large braking force, stability and accuracy, long-term use, and no attenuation.
- 3、The special cross roller bearing for the YRT turntable is adopted, which has higher radial load capacity, rigidity, and precision retention.
- 4、Adopting an integrated box structure, the structure is more compact and stable.
- 5、Imported seals are used, oil-resistant, water-resistant, high-temperature-resistant, and have a longer service time.

DD-DB-125 Parameters Table

| Item | Inclined axis | Axis of rotation |
|---|--|--|
| Rotary Table Diameter(mm) | - | Φ 125 |
| Maximum rotation diameter (mm) | - | Φ 200 |
| Disk axial runout (mm) | - | 0.01 |
| Disk radial runout (mm) | - | 0.01 |
| Width for Located Block at the bottom(mm) | 14 | - |
| Brake pressure (MPa) | Barometric pressure 0.6 | Barometric pressure 0.6 |
| Braking torque (NM) | 300 | 90 |
| Rated voltage (V) | 380 | 380 |
| Rated/peak torque (NM) | 176/318 | 28/56 |
| Rated/peak current(A) | 7.73/17.96 | 4.8/10.6 |
| Maximum speed(rpm) | 100 | 200 |
| Positioning accuracy(") | 20 | 20 |
| Index Repeatability(") | 4 | 4 |
| Allowable load weight when braking-(Kg) | | Horizontal: 16 Tilt: 12 |
| Rotation angle | ± 110 | Any angle |
| Encoder | According to the system confirmation, 23-26 digits | According to the system confirmation, 23-26 digits |
| Servo drive (optional) | F(β iSV 80-B) | F(β iSV 40-B) |
| | M(EJ-V1-40B) | M(EJ-V1-30B) |
| | S(6SL3120-1TE21) | S(6SL3120-1TE15) |
| Total weight(Kg) | 110 | - |

DD-DB-125

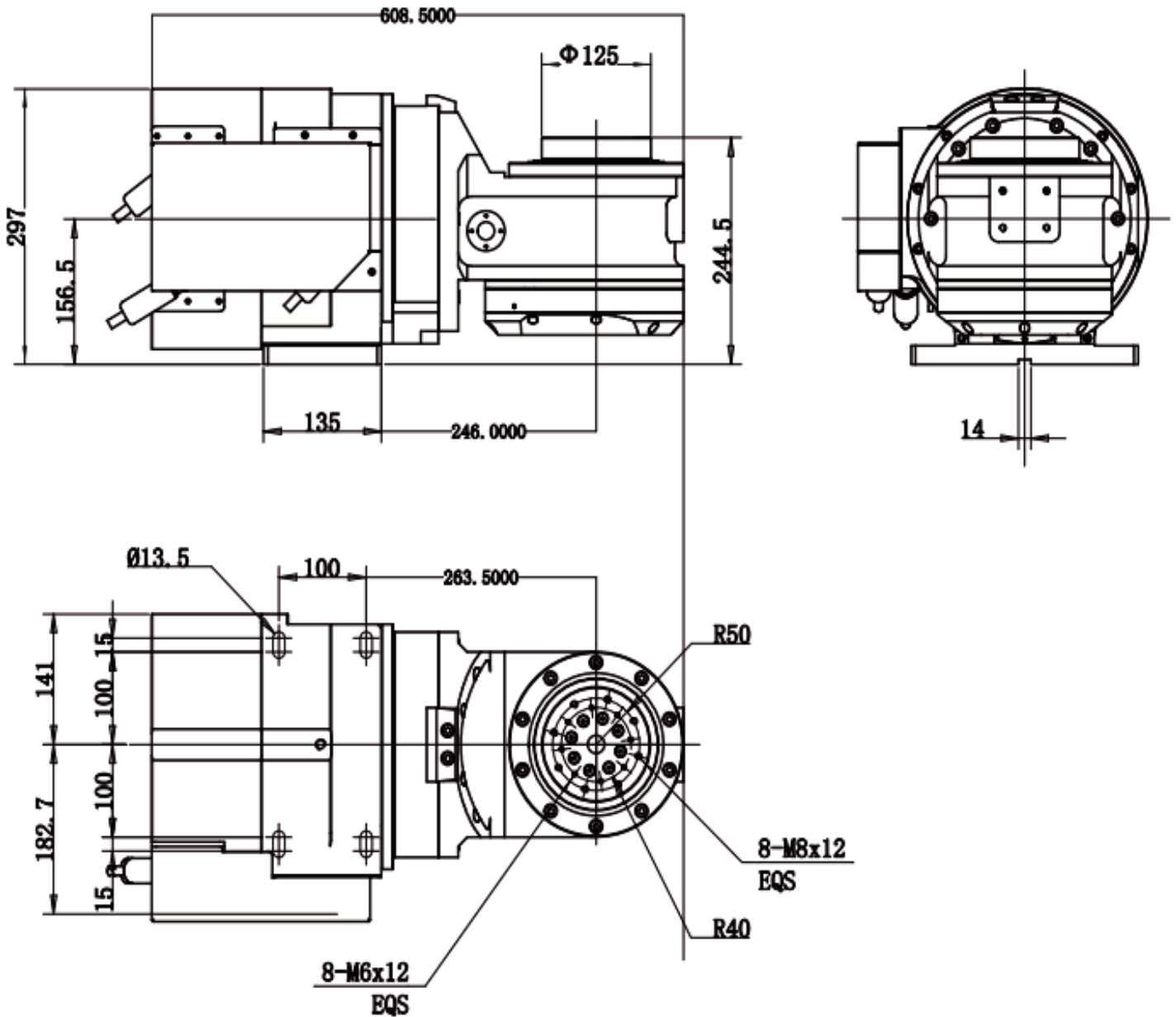
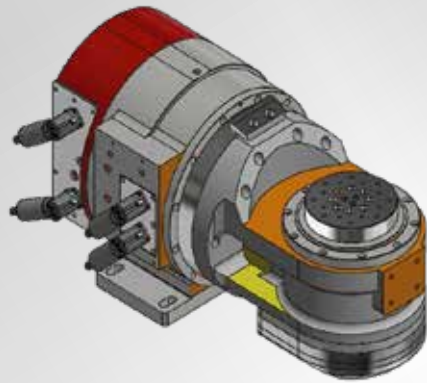

DD-DB-160 Parameters Table

| Item | Inclined axis | Axis of rotation |
|---|--|--|
| Rotary Table Diameter(mm) | - | Φ 160 |
| Maximum rotation diameter (mm) | - | Φ 200 |
| Disk axial runout (mm) | - | 0.01 |
| Disk radial runout (mm) | - | 0.01 |
| Width for Located Block at the bottom(mm) | 14 | - |
| Brake pressure (MPa) | Barometric pressure 0.6 | Barometric pressure 0.6 |
| Braking torque (NM) | 300 | 90 |
| Rated voltage (V) | 380 | 380 |
| Rated/peak torque (NM) | 176/318 | 33/60 |
| Rated/peak current(A) | 7.73/17.96 | 5.2/11.8 |
| Maximum speed(rpm) | 100 | 200 |
| positioning accuracy(") | 20 | 20 |
| Index Repeatability | 4 | 4 |
| Allowable load weight when braking (Kg) | - | Level: 18 Tilt: 14 |
| Rotation angle | ± 110 | Any angle |
| Encoder | According to the system confirmation, 23-26 digits | According to the system confirmation, 23-26 digits |
| Servo drive (optional) | F (β iSV 80-B) | F(β iSV 40-B) |
| | M(EJ-V1-40B) | M(EJ-V1-30B) |
| | S(6SL3120-1TE21) | S(6SL3120-1TE15) |
| Total weight(Kg) | 110 | - |

DD-DB-160

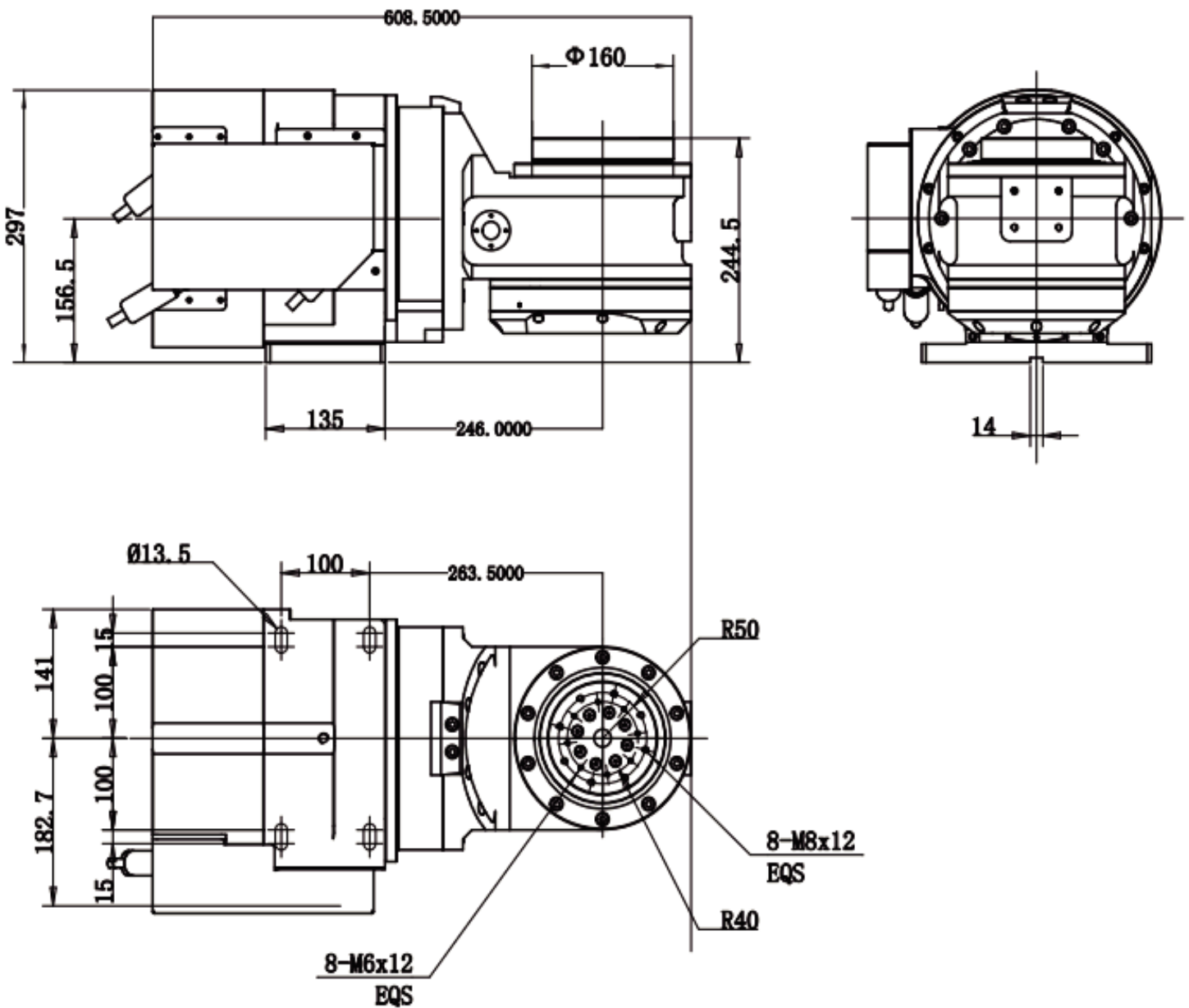
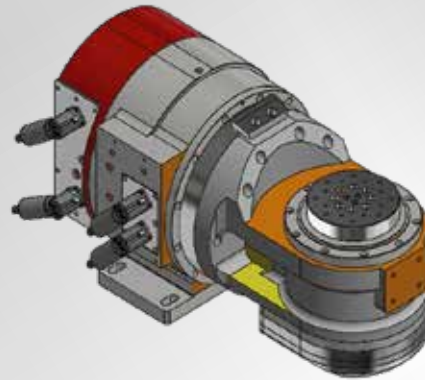

DD-DB-200 Parameters Table

| Item | Inclined axis | Axis of rotation |
|---|--|--|
| Rotary Table Diameter(mm) | - | Φ200 |
| Maximum rotation diameter (mm) | - | Φ200 |
| Disk axial runout (mm) | - | 0.01 |
| Disk radial runout (mm) | - | 0.01 |
| Width for Located Block at the bottom(mm) | 14 | - |
| Brake pressure (MPa) | Barometric pressure 0.6 | Barometric pressure 0.6 |
| Braking torque (NM) | 300 | 90 |
| Rated voltage (V) | 380 | 380 |
| Rated/peak torque (NM) | 176/318 | 39/66 |
| Rated/peak current(A) | 7.73/17.96 | 5.91/12.99 |
| Maximum speed(rpm) | 100 | 200 |
| positioning accuracy(") | 20 | 20 |
| Index Repeatability(") | 4 | 4 |
| Allowable load weight when braking (Kg) | - | Level: 20 Tilt: 15 |
| Rotation angle | ± 110 | Any angle |
| Encoder | According to the system confirmation, 23-26 digits | According to the system confirmation, 23-26 digits |
| Servo drive (optional) | F(β iSV 80-B) | F(β iSV 40-B) |
| | M(EJ-V1-40B) | M(EJ-V1-30B) |
| | S(6SL3120-1TE21) | S(6SL3120-1TE15) |
| Total weight(Kg) | 110 | - |

DD-DB-200

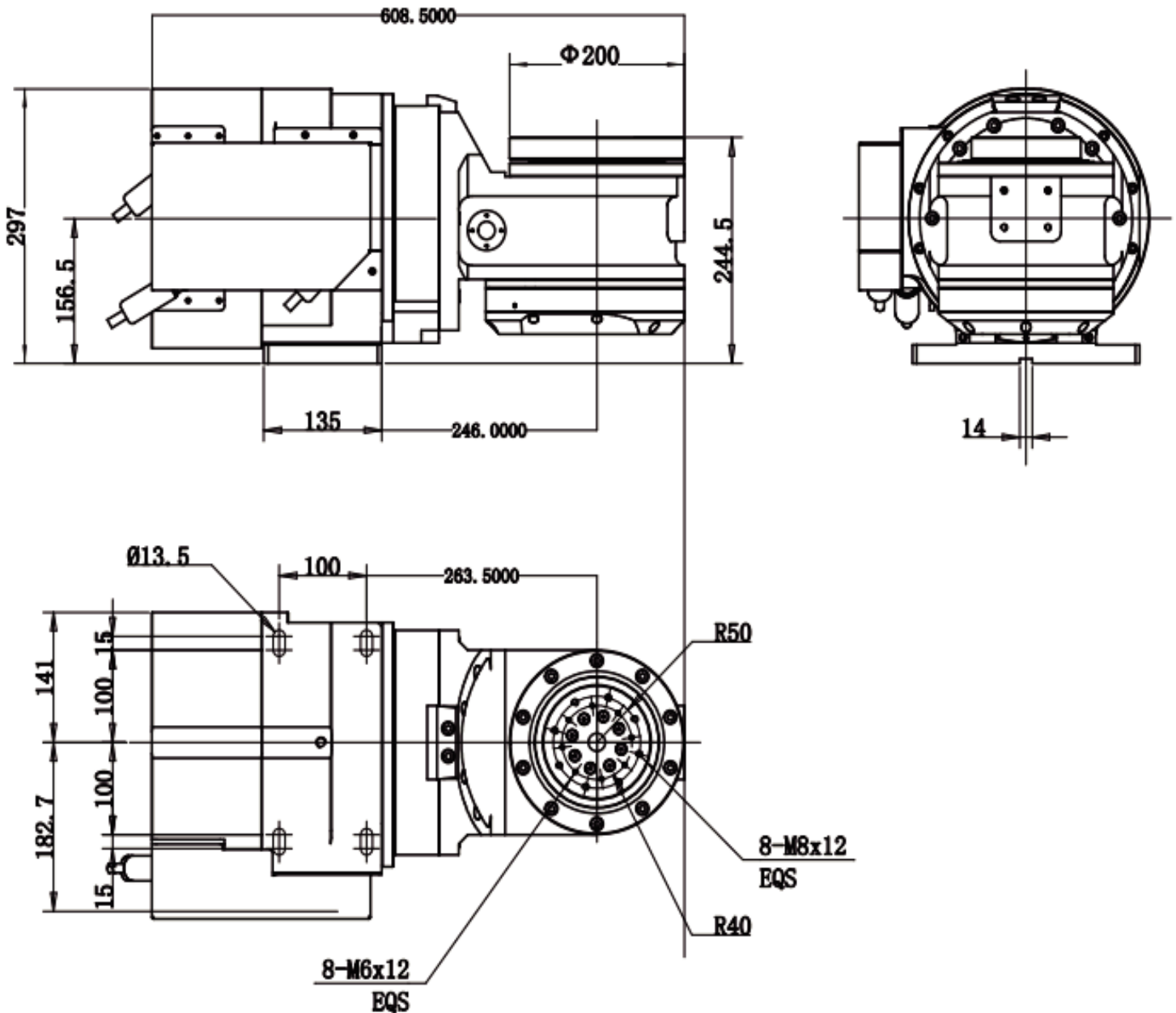
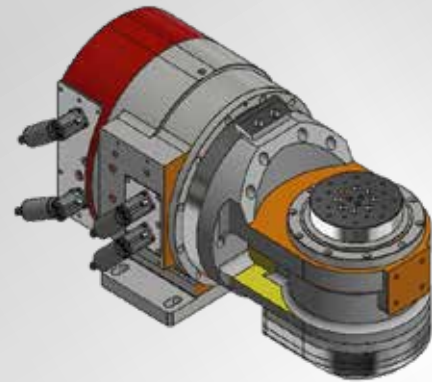

DD-YL-250 Parameters Table

| Item | Inclined axis | Axis of rotation |
|---|--|--|
| Rotary Table Diameter(mm) | - | Φ250 |
| Maximum rotation diameter (mm) | - | Φ350 |
| Disk axial runout (mm) | - | 0.01 |
| Disk radial runout (mm) | - | 0.01 |
| Width for Located Block at the bottom(mm) | 14 | - |
| Brake pressure (MPa) | Oil pressure 25-30Kg/cm ² | Oil pressure 25-30Kg/cm ² |
| Braking torque (NM) | 400 | 200 |
| Rated voltage (V) | 380 | 380 |
| Rated/peak torque (NM) | 244/650 (543/1030) | 80/150 (174/318) |
| Rated/peak current(A) | 5.8 (12.86) /17.96 | 3.84 (7.73) /12.99 |
| Maximum speed(rpm) | 100 | 200 |
| positioning accuracy(") | 20 | 15 |
| Index Repeatability(") | 4 | 4 |
| Allowable load weight when braking (Kg) | - | Horizontal: 40 Tilt: 35 |
| Rotation angle | ± 120 | Any angle |
| Encoder | According to the system confirmation, 23-26 digits | According to the system confirmation, 23-26 digits |
| Servo drive (optional) | F(β iSV 80-B) | F(β iSV 40-B) |
| | M(EJ-V1-80B) | M(EJ-V1-30B) |
| | S(6SL3120-1TE21) | S(6SL3120-1TE15) |
| Total weight(Kg) | 155 | - |

DD-YL-250

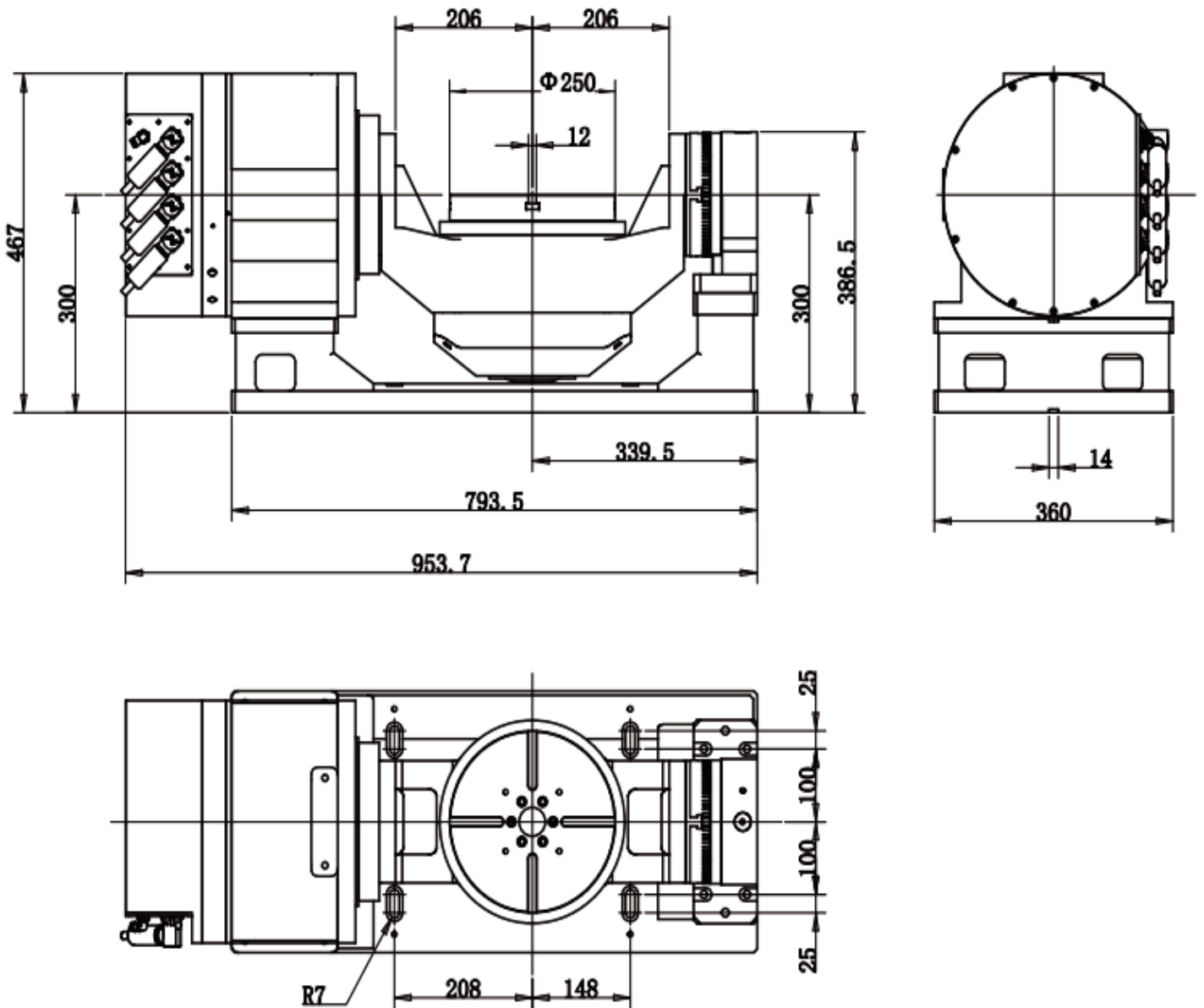
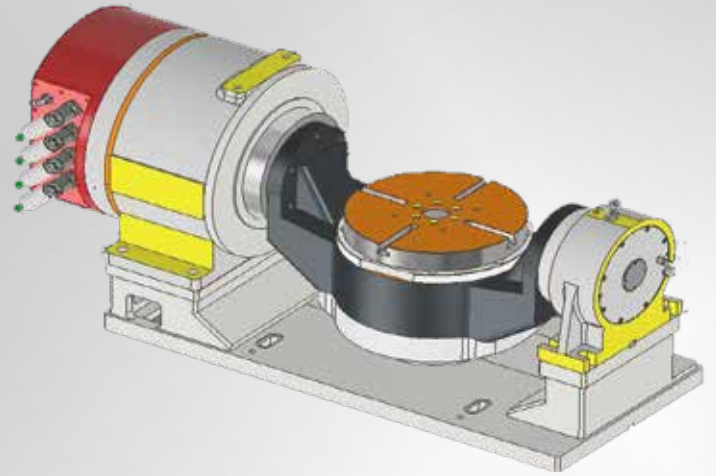

Roller Cam Five-Axis Rotary Table

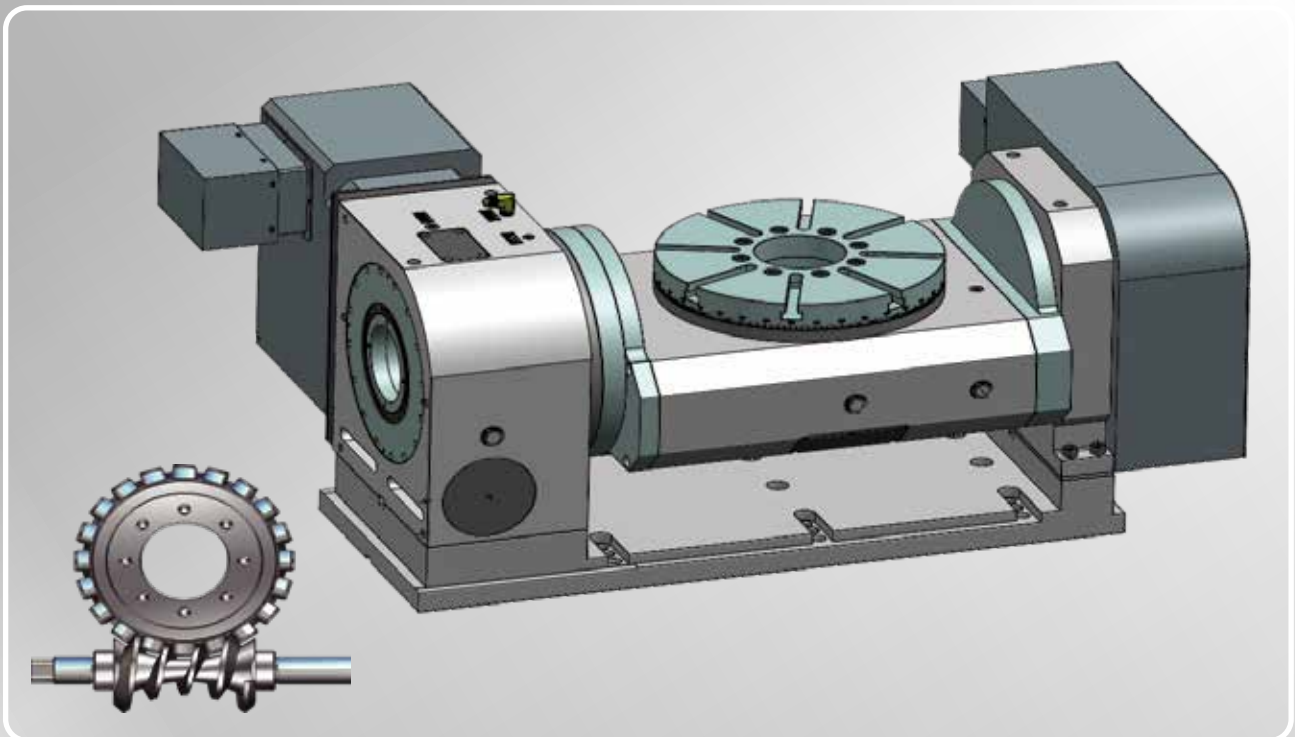

Features:

- 1、The core transmission mechanism adopts a cam transmission mechanism, which is high-precision, has zero backlashes, and is wear-resistant.
- 2、 The whole series adopts a hydraulic full-circumference brake mechanism, with fast braking response (no delay) and large braking force, Stable, accurate, and long-term use, with no attenuation.
- 3、The whole series adopts YRT series turntable special crossed roller bearings, with higher radial load capacity. better rigidity, and the entire machine's accuracy retention.
- 4、The design of the whole machine adopts imported seals, which are resistant to oil, water, and high temperature, and have a longer service time.

TB-YL-350 Parameters Table

| Item | Inclined axis | Axis of rotation |
|---|--------------------|--------------------|
| Rotary Table Diameter(mm) | - | Φ350 |
| Plate Height-Horizontal(mm) | - | 400 |
| Disk axial runout (mm) | - | 0.01 |
| Disk radial runout (mm) | - | 0.01 |
| Table rotation center height (mm) | - | 300 |
| Table T-slot width | - | 14h7 |
| Width for Located Block at the bottom(mm) | 18h7 | - |
| Route | -110° - 110° | Any angle |
| Applicable ambient temperature | 10-50 | - |
| Brake pressure (MPa) | Oil pressure 30-35 | Oil pressure 30-35 |
| Least Input Increment | 0.001 | 0.001 |
| positioning accuracy(") | 30 | 20 |
| Index Repeatability(") | 8 | 8 |
| Reduction ratio | 1: 72 | 1: 72 |
| Allowable load (Kg) | Tilt 160 | Level 200 |
| Allowable cutting torque (KG.M) | Tilt 160 | Level 180 |
| Servo drive, motor (optional) | F(β iS22) | F(β iS12) |
| | M(HF-204) | M(HF-154) |
| Total weight(Kg) | 585 | - |

TB-YL-350

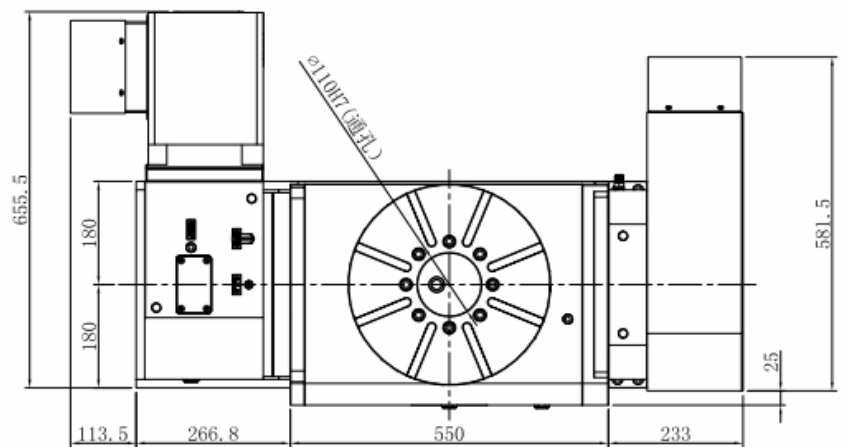
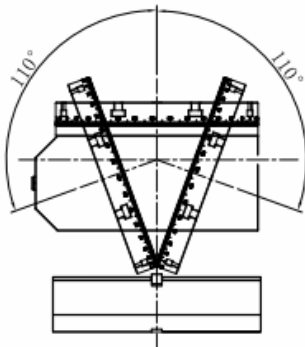
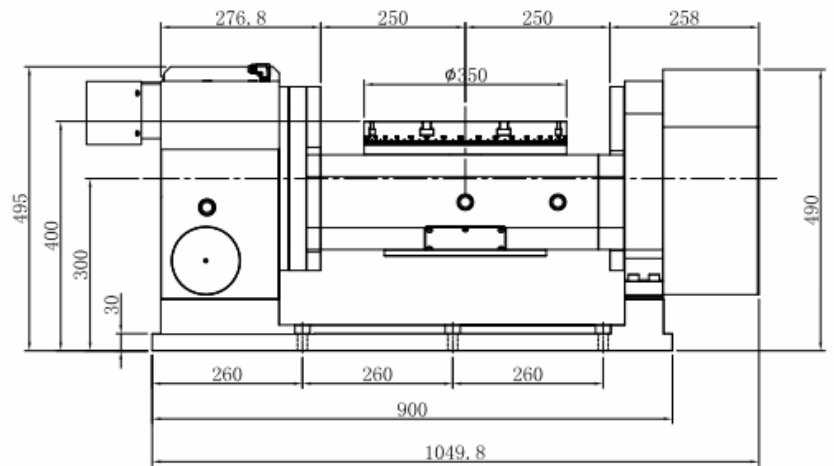
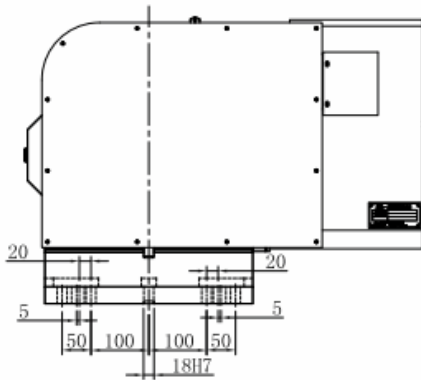
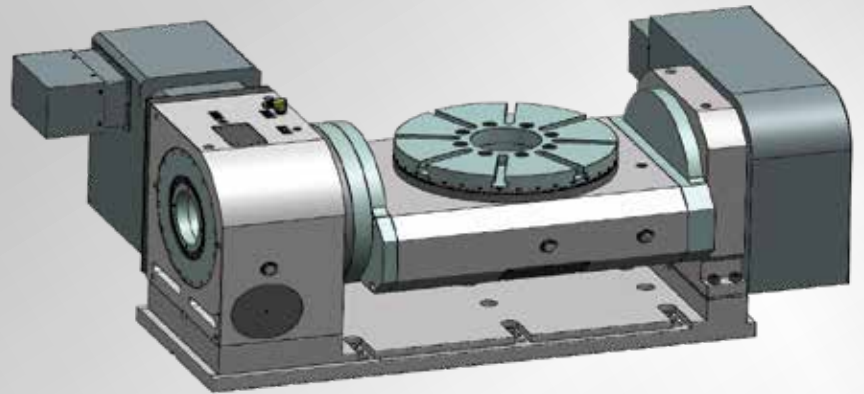

TB-DB-165 Parameters Table

| Item | Inclined axis | Axis of rotation |
|---|--------------------|------------------|
| Rotary Table Diameter(mm) | - | Φ 165 |
| Disk height-horizontal(mm) | - | 280 |
| Disk axial runout (mm) | - | 0.01 |
| Disk radial runout (mm) | - | 0.01 |
| Table rotation center height (mm) | - | 195 |
| Workbench center hole diameter | - | 25h7 |
| Width for Located Block at the bottom(mm) | 18h7 | - |
| Route | -110° - 110° | Any angle |
| Applicable ambient temperature °C | 10-50 | - |
| Brake pressure(Kg/cm ²) | Oil pressure 30-35 | - |
| Equal division minimum angle | 0.001 | 0.001 |
| Positioning accuracy(") | 30 | 25 |
| Index Repeatability(") | 8 | 8 |
| Reduction ratio | 1: 60 | 1: 81 |
| Allowable load (Kg) | - | 20 |
| Allowable cutting torque (KG.M) | - | 8.5-20 |
| | F(α1F4/β iS8) | F(α1F2/β iS4) |
| Servo drive, motor (optional) | - | - |
| Total weight(Kg) | 136 | - |

TB-DB-165

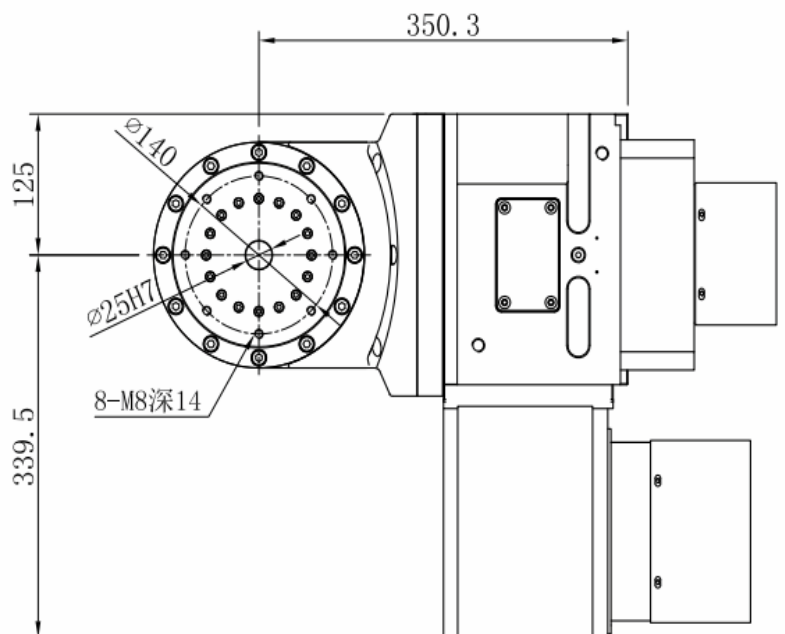
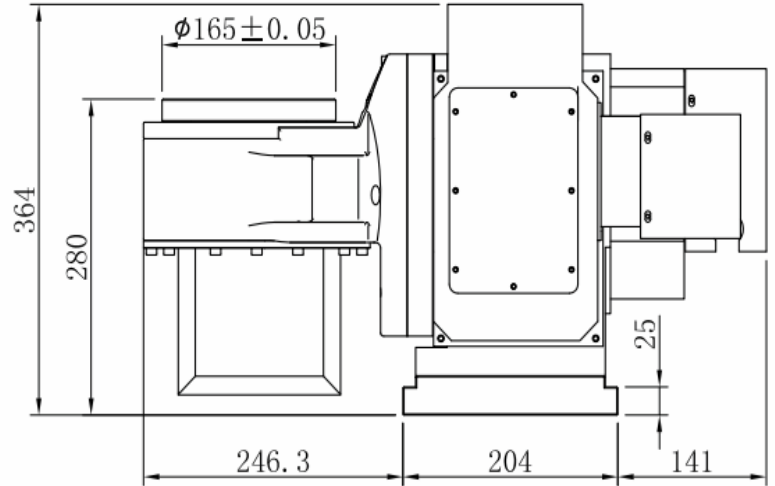
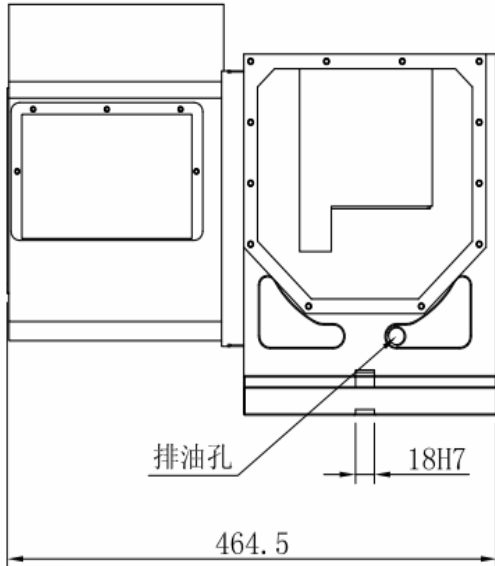
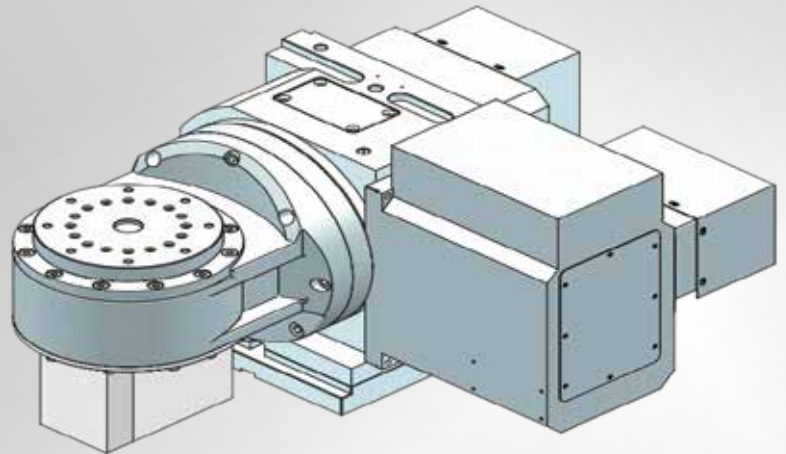

Shanghai Think Big Machine Tool Co.,Ltd



Shanghai Think Big Machine Tool Co.,Ltd
上海森克贝客机械工具有限公司

Address: Building 19, #199 East Guangfulin Road, Songjiang District, 201613, Shanghai, China

Telephone: +86 021 57898131

Email: manage@tbmtool.com